

wingo

window-systems



ISSUE
01.2012

2012

★ ★ ★ ★ ★

GARGIULO GmbH

TABLE OF CONTENTS

wingo AD	side 3 - 27
Certificates	28 - 30
Alpsteg SWISS MD	31 - 43
Certificates	44
wingo PERFETTO	45 - 51
Laminating	52 - 55
Pultrusion of fibre glass	56 - 57
VG-PE insulation material	58
Mouldings PS	59
Floorboards Enzo-D	60 - 61
GARGIULO GmbH	62 - 63



system wingo AD programme

The wingo AD window system persuades with its timeless line management and the slim profile contour. They recreate the expression form of the architecture and continue it constantly. The numerousness of wood and coloured coatings emphasize the features not only in the interiors. Also the facade design profits from the colour variety and the additional possibility to match the outer frame to the vent frame.

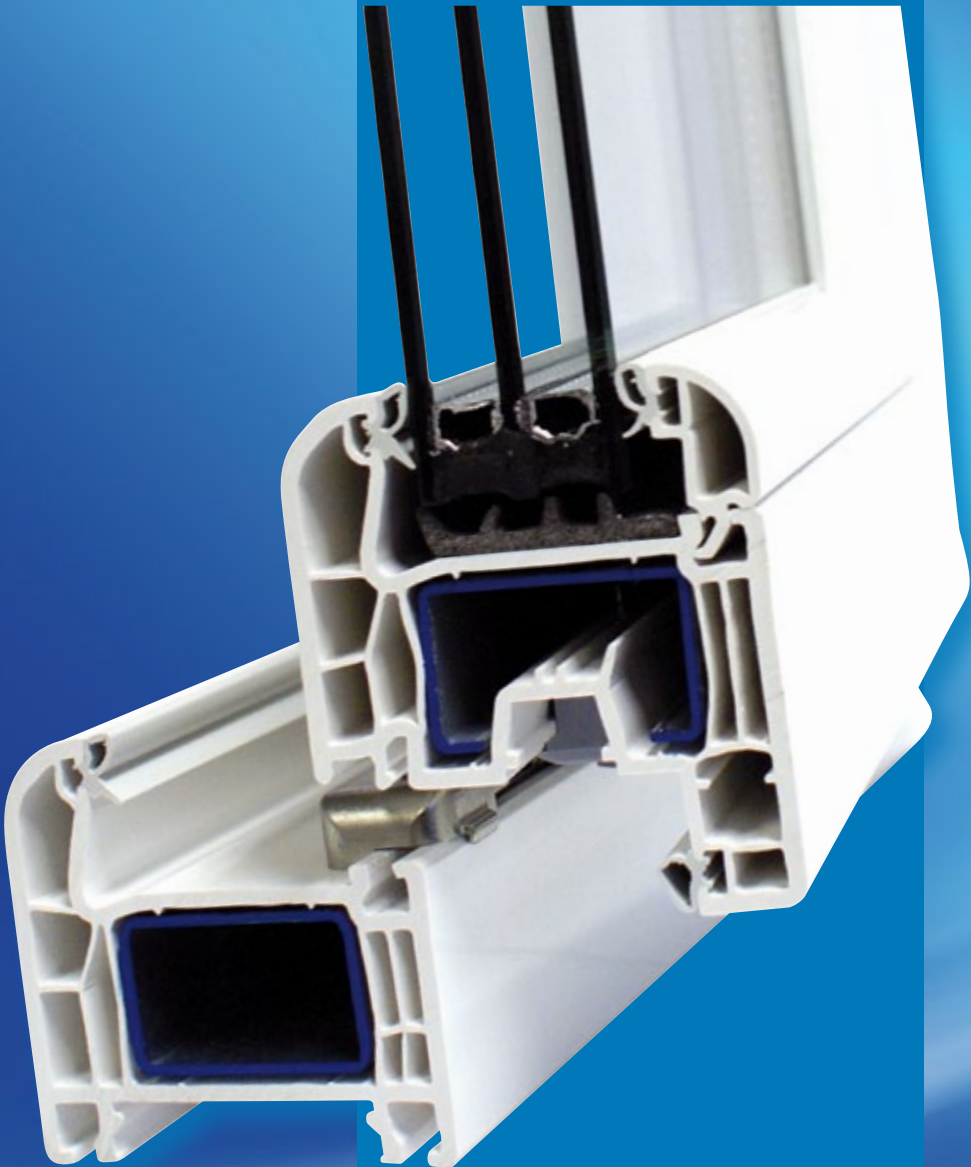

PVC systems wingo AD • Main profiles / Outer frames

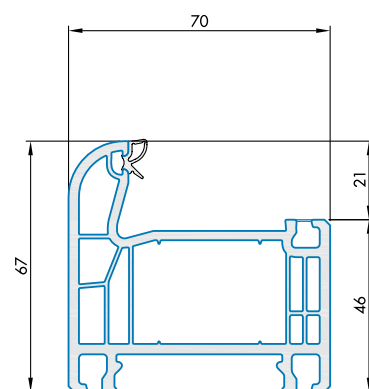

Outer frame
1101 ..

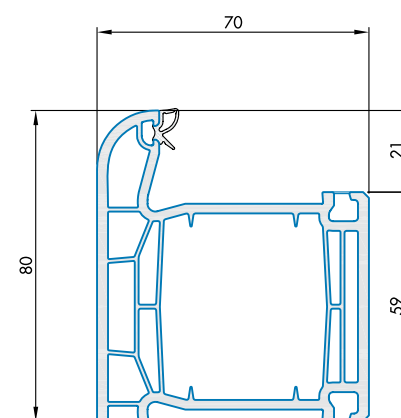

Outer frame 80 mm
1116 ..

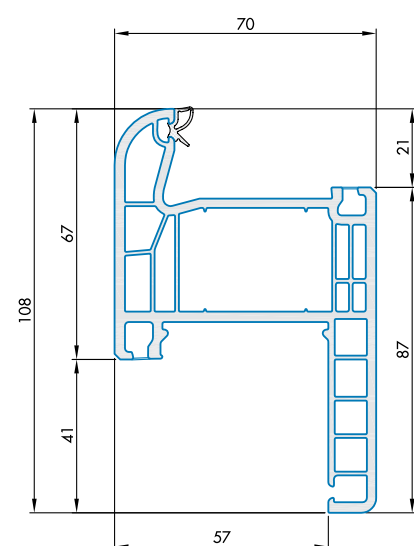

Outer frame with inside stop
1105 ..

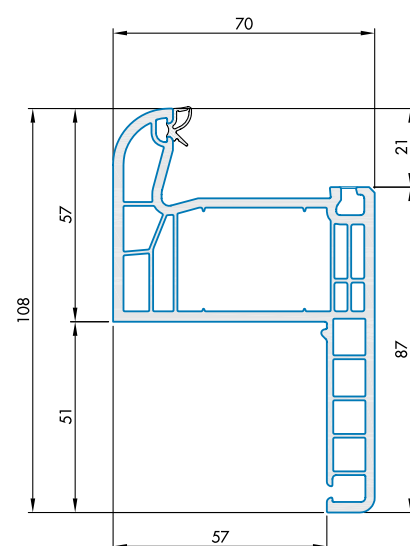

Outer frame with inside stop 51 mm
1113 ..

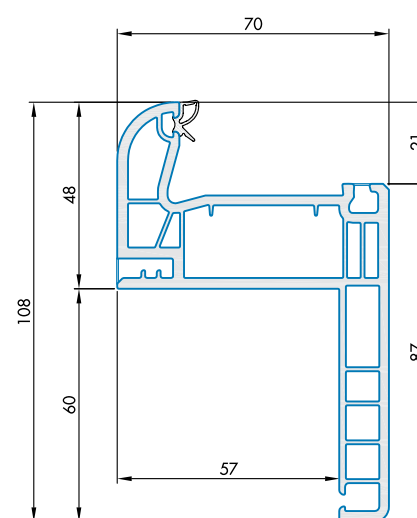

Outer frame - renovation
1106 ..

PVC systems wingo AD • Main profiles / Vent frames

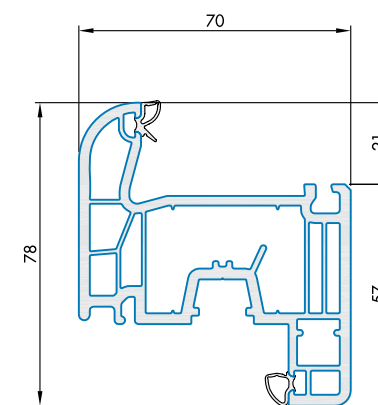

Vent frame rebated
1102 ..

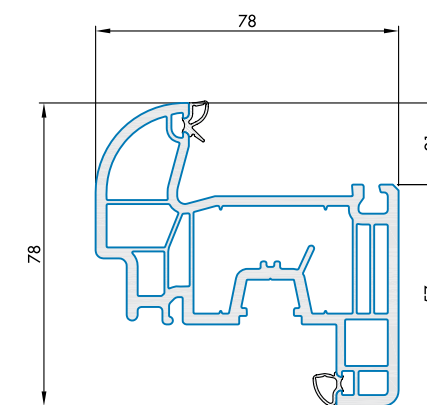

Vent frame semi-flush rounded
1103 ..

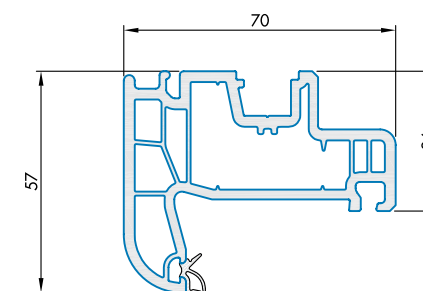

Meeting stile vent frame rebated
1107 ..

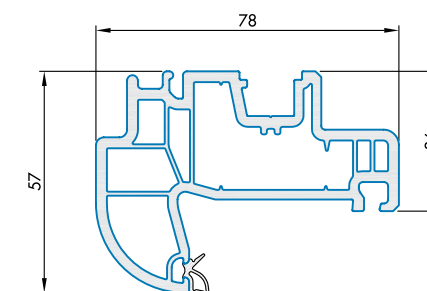

Meeting stile vent frame semi-flush rounded
1108 ..

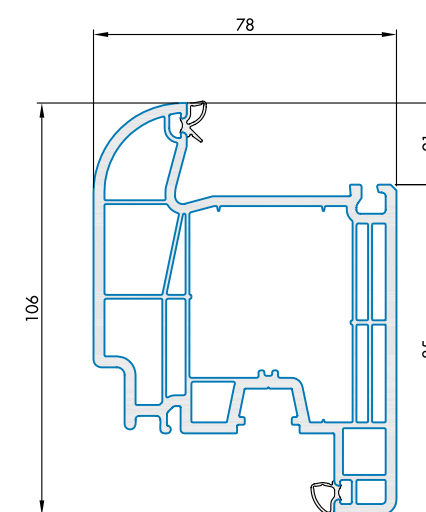

French window vent frame semi-flush rounded
1112 ..

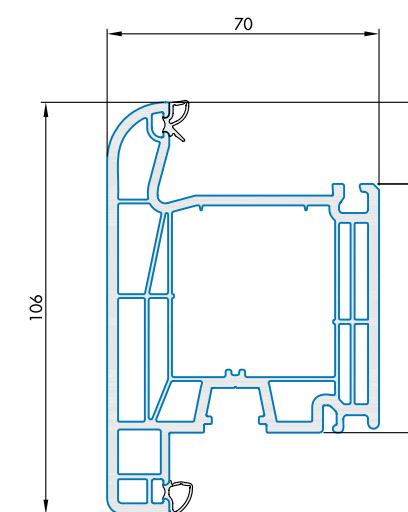

Vent frame with opening outwards
1114 ..

PVC systems wingo AD • Main profiles / Outer frames

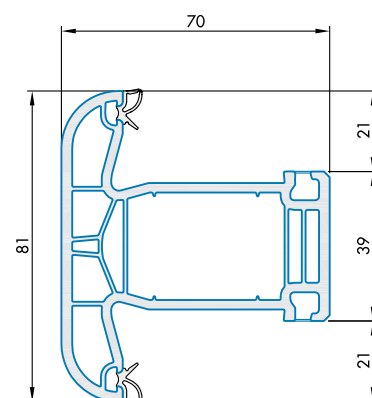

Mullion
1104 ..

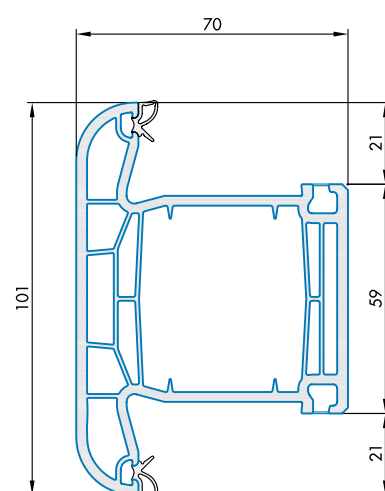

Mullion - 101 mm
1115 ..

PVC systems wingo AD • Secondary profiles

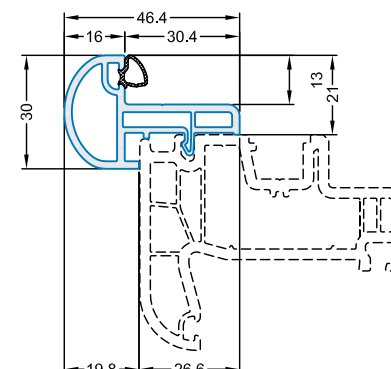

Meeting stile profile small
1201 ..

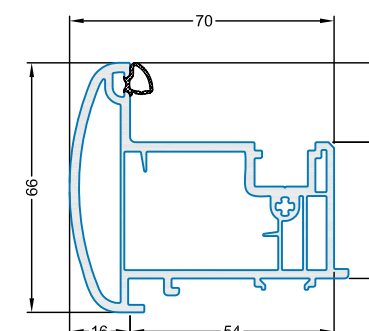

Meeting stile profile large
1202 ..

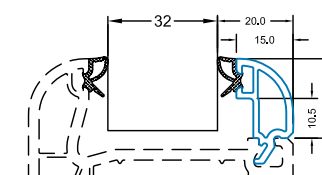

Glazing bead 32
Glazing wingo: 32 mm
1203 ..

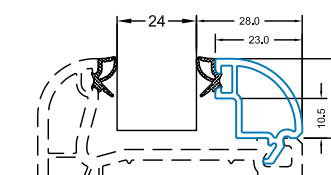

Glazing bead 24
Glazing wingo: 24 mm
1204 ..

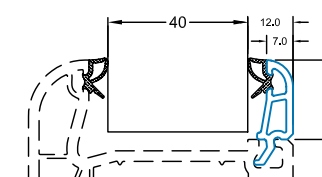

Glazing bead 7 mm*
Glazing wingo: 40 mm
1211 ..

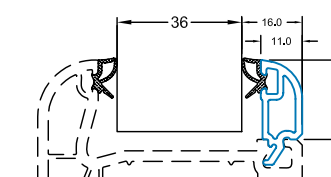

Glazing bead 11 mm*
Glazing wingo: 36 mm
1212 ..



Rebate gasket TPE
1617 00 black
1617 04 papyrus white



Glass gasket TPE
1618 00 black
1618 04 papyrus white

General secondary profiles

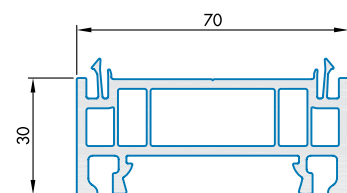

Extension profile 30 mm
7212 ..

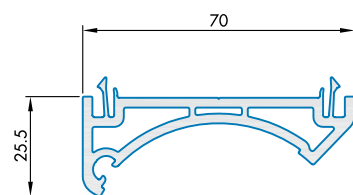

Corner profile variable
7210 ..

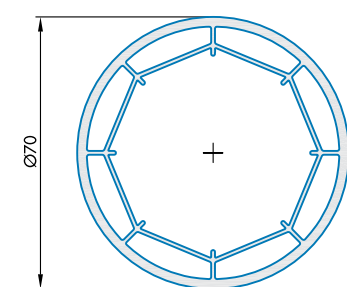

PVC-U tube
7297 ..

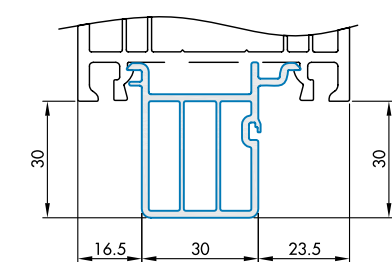

Connection profile of window sill
7275 00

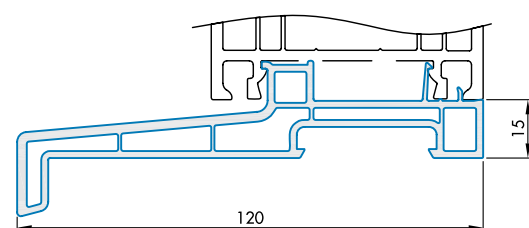

Window sill profile 120x15
7515 ..

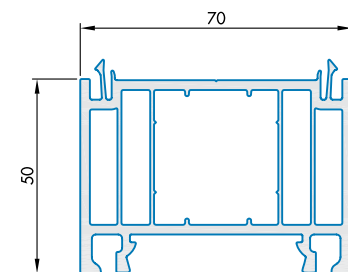

Extension profile 50 mm
7213 ..

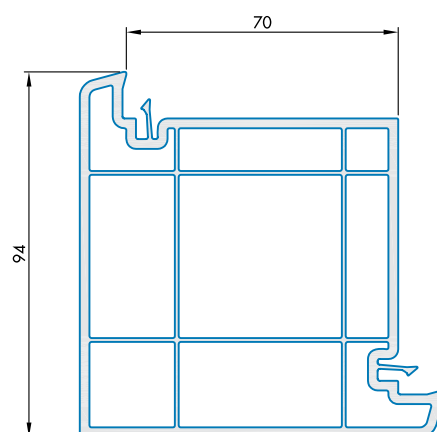

Corner profile 90°
7207 ..

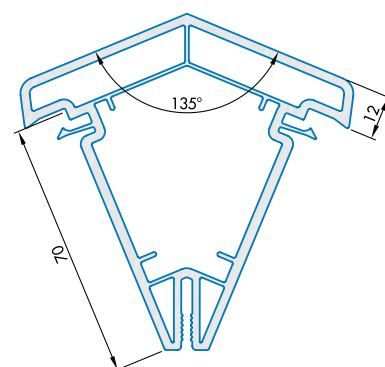

Corner profile 135°
7208 ..

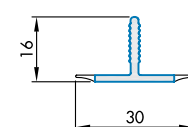

T-Profil
7209 ..

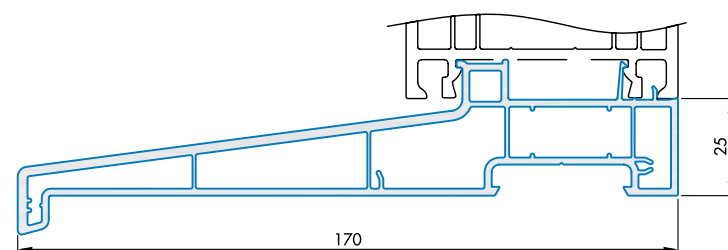

Window sill profile 170x25
7516 ..

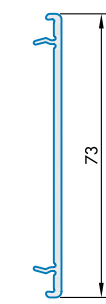

Cover profile
7288 ..

General secondary profiles

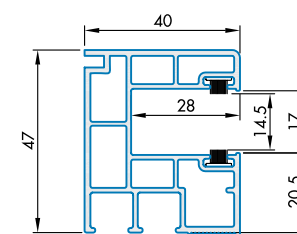

Guide bar of roller shutter
930 B2

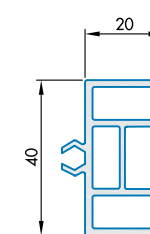

Duplication
Guide bar of roller shutter
930

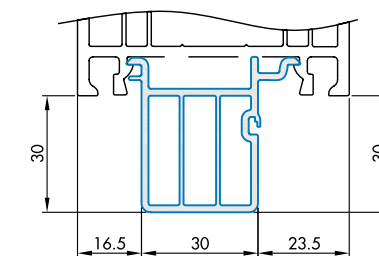

Connection profile of window sill
7275 00

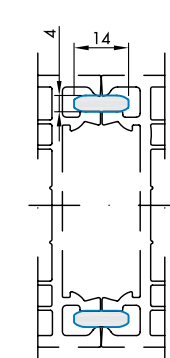

Connecting piece
7236 ..

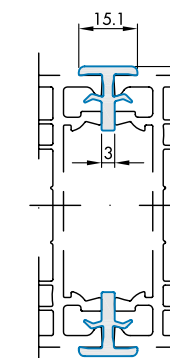

Connecting piece
7225 ..

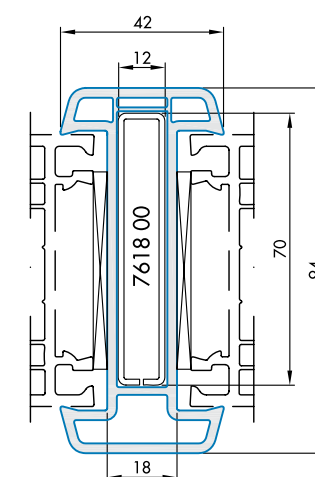

Frame coupling
7270 ..

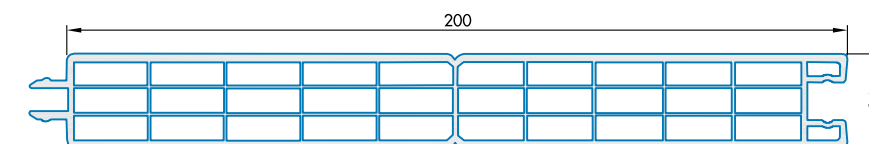

Panel
030 ..

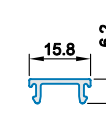

Cover strip
7235 ..

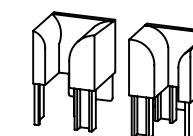

Hopper for 930 B2
932 white
932 B brown



Rebate gasket EPDM
7602 00 black
7602 04 papyrus white



Glass gasket EPDM
2609 00 black
2609 04 papyrus white

PVC systems
General secondary profiles

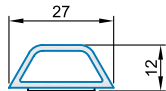

Glazing beat 27 R4
7239 ..

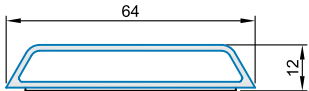

Glazing beat 64 R4
7241 ..

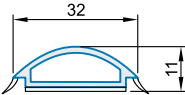

Glazing beat round
078657

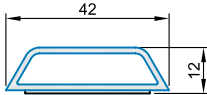

Glazing beat 42 R4
7240 ..



Glazing beat 85 R4
7242 ..

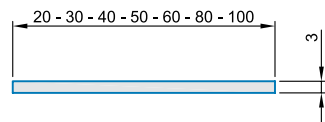

Flat section
20/3 1205 ..
30/3 1206 ..
40/3 1207 ..
50/3 1208 ..
60/3 1209 ..
80/3 1210 ..
100/3 1213 ..

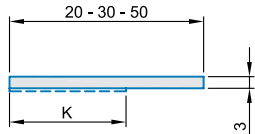

Flat section
with adhesive type
20/3 K12 078199
30/3 K19 078201
40/3 K30 078207
50/3 K30 078203

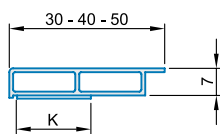

Chamber profile
with adhesive type
30/7 K15 078243
40/7 K19 078244
50/7 K19 078246

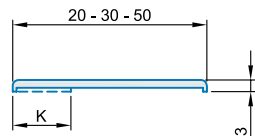

Flat section
with adhesive type
20/3 K12 078120
30/3 K15 078130
40/3 K15 078140
50/3 K15 078150
60/3 K15 078160

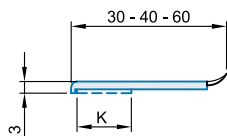

Flat section
with lip and adhesive type
30/3 K15 078201 WL
40/3 K15 078207 WL
60/3 K19 078208 WL

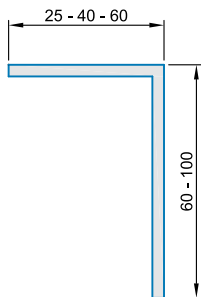

Angular profile
60/40/3 546 ..
60/60/3 547 ..
60/25/2 550 ..
100/60/3 561 ..

PVC systems
wingo AD • Sections / outer frames / vent frames

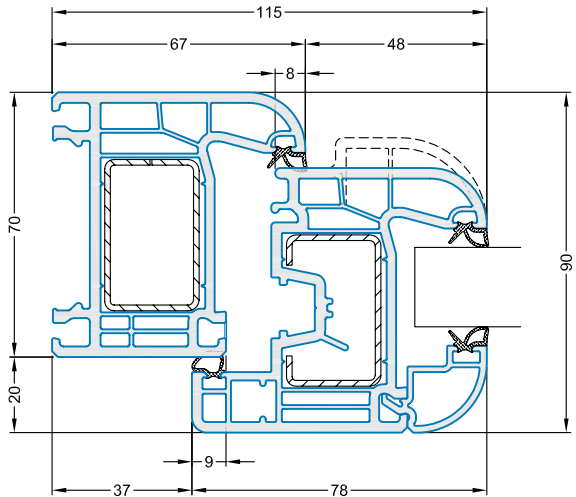

Outer frame 1101 ..
Vent frame 1102 .. / 1103 ..
Glazing bead 1204 ..

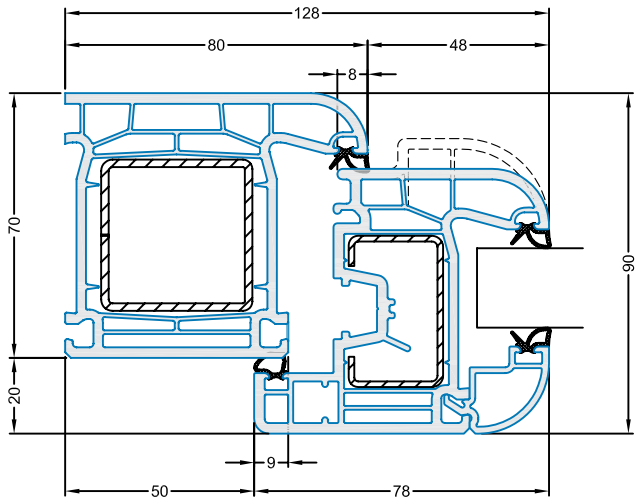

Outer frame 1116 ..
Vent frame 1102 .. / 1103 ..
Glazing bead 1204 ..

PVC systems
wingo AD • Sections / outer frames / vent frames

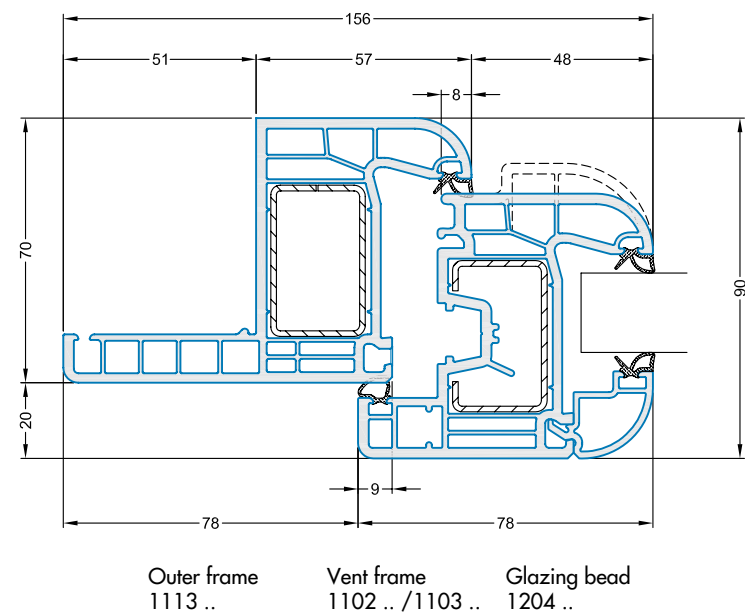
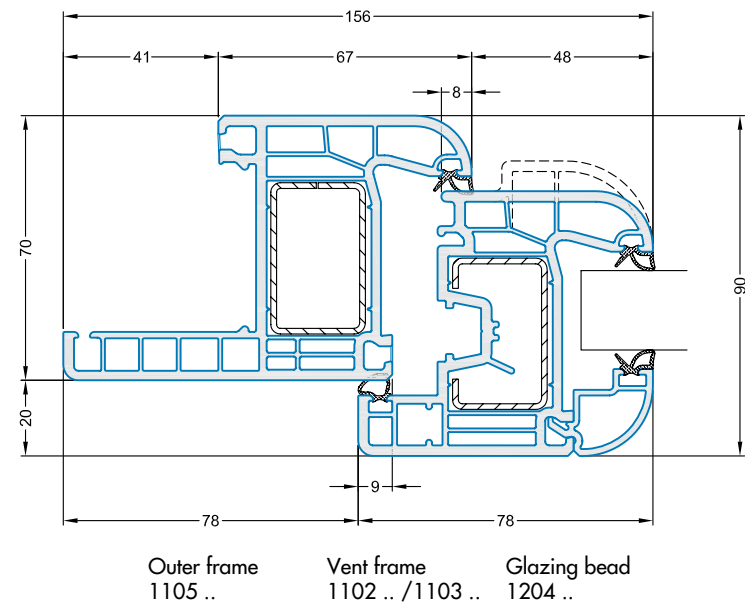

PVC systems
wingo AD • Sections / outer frames / vent frames

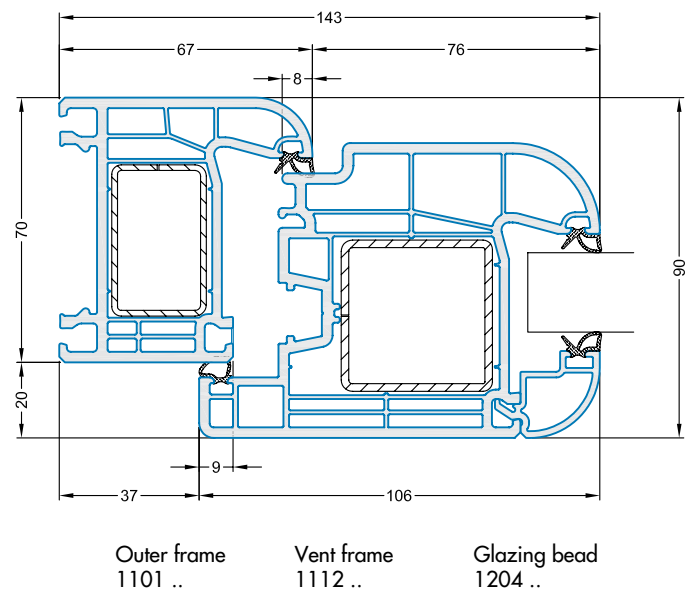
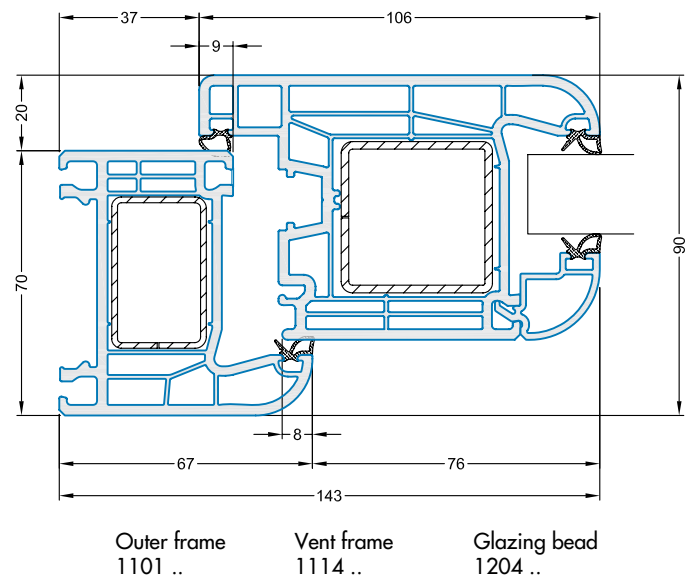

PVC systems
wingo AD • Sections / outer frames / vent frames

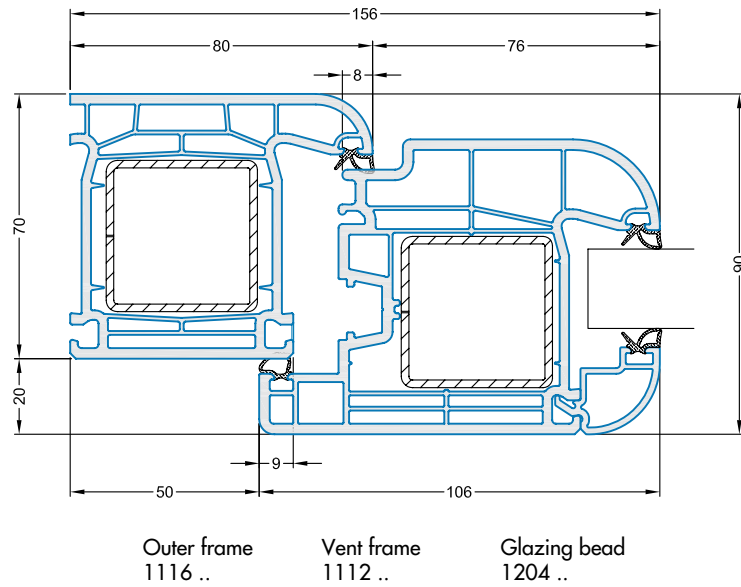
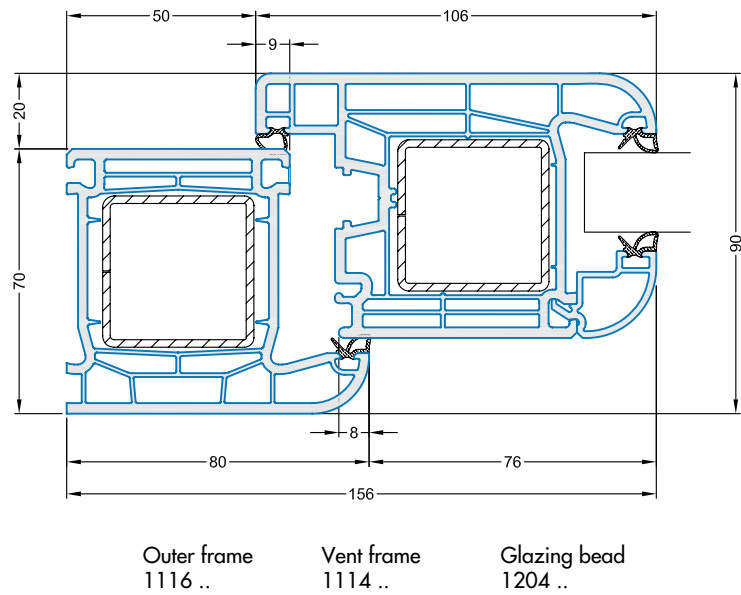

PVC systems
wingo AD • Sections / outer frames / vent frames

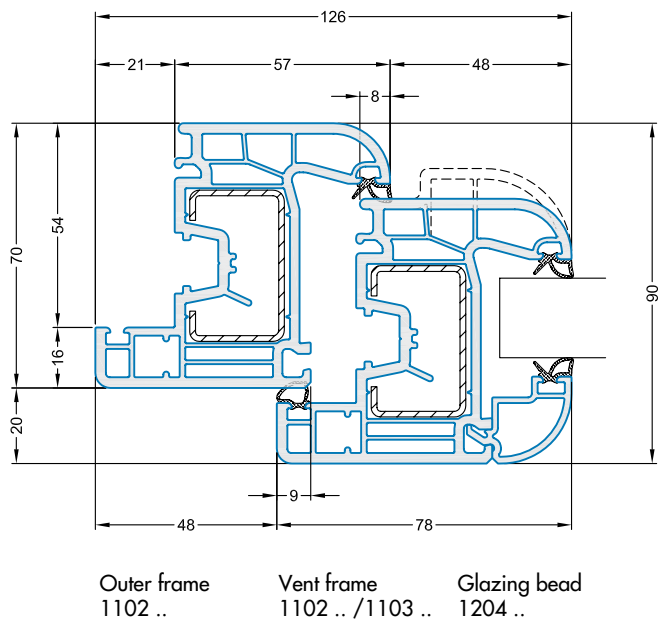
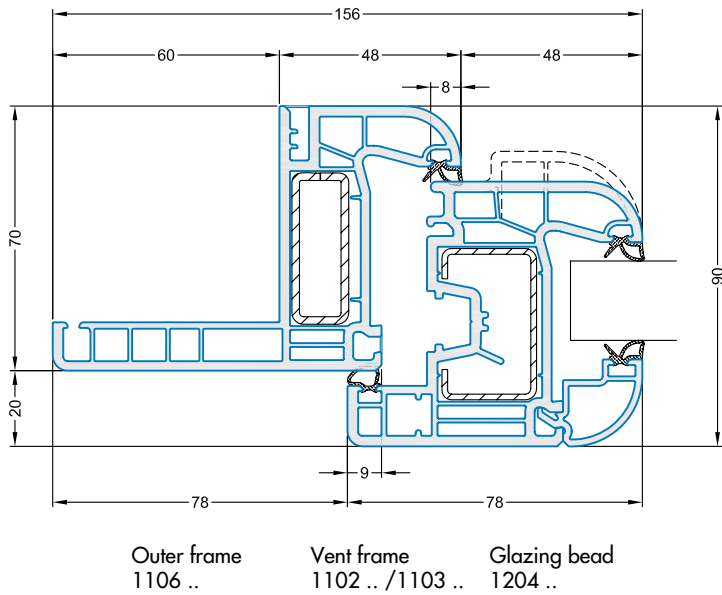

PVC systems wingo AD • Sections / Meeting stile profiles

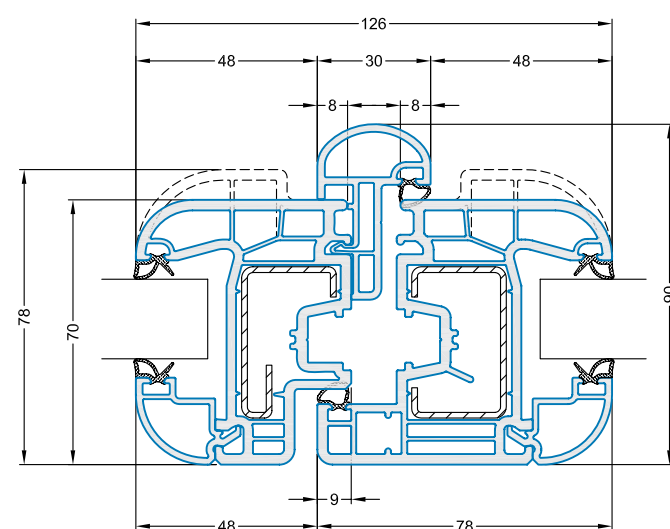

Vent frame 1102 .. /1103 .. Meeting stile profile 1201 .. Glazing bead 1204 ..

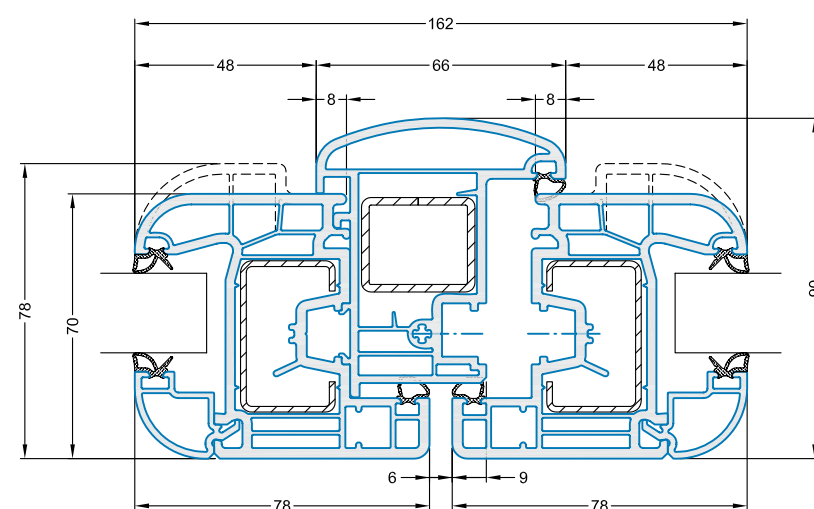

Vent frame 1102 .. /1103 .. Meeting stile profile 1202 .. Glazing bead 1204 ..

PVC systems wingo AD • Sections / Mullions

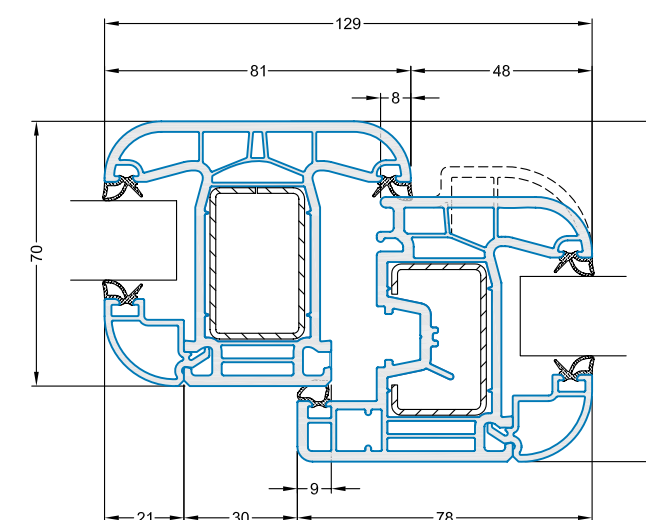

Mullion 1104 .. Vent frame 1102 .. /1103 .. Glazing bead 1204 ..

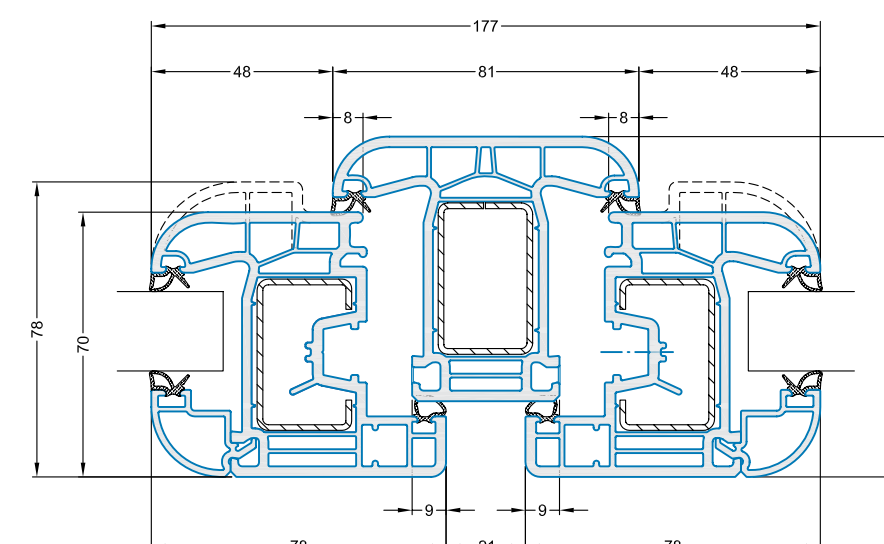

Vent frame 1102 .. /1103 .. Mullion 1104 .. Glazing bead 1204 ..

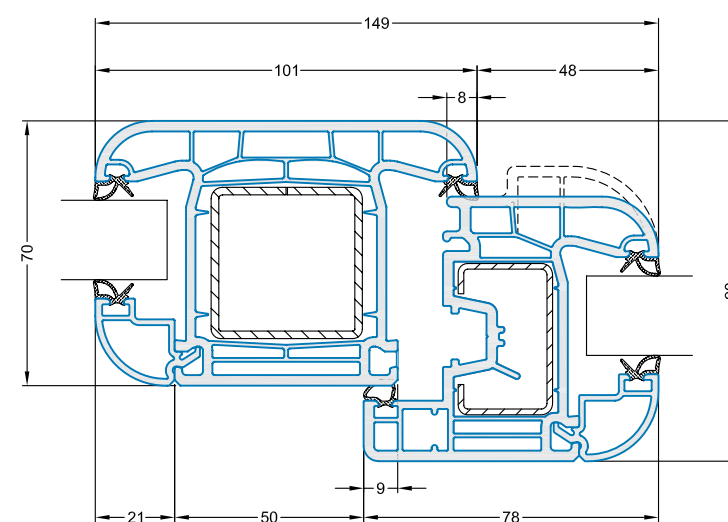

Mullion 1115 ..
Vent frame 1102 .. / 1103 ..
Glazing bead 1204 ..

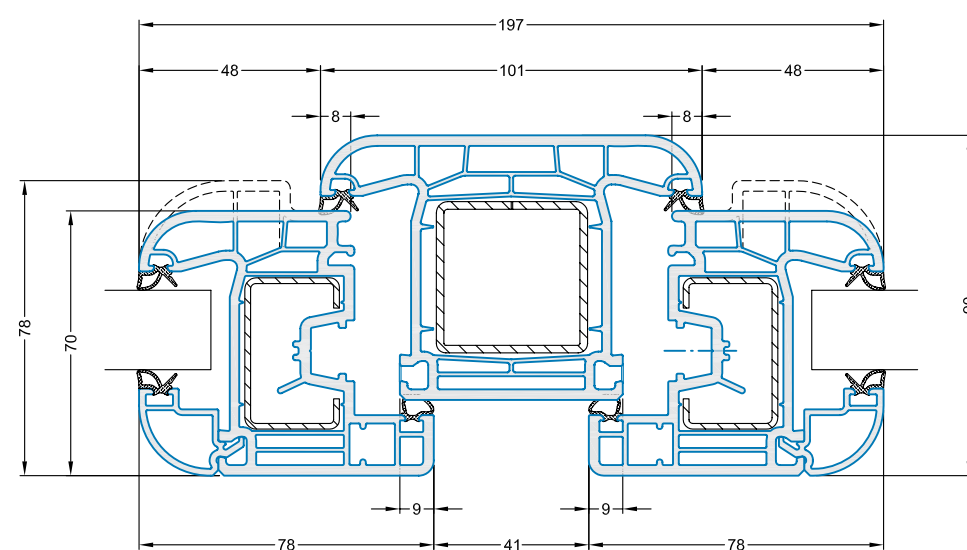

Vent frame 1102 .. / 1103 ..
Mullion 1115 ..
Glazing bead 1204 ..

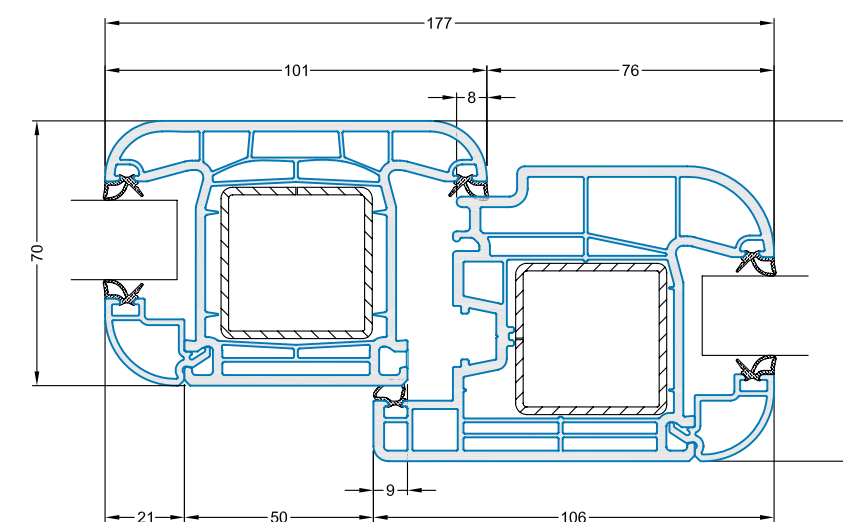

Outer frame 1116 ..
Vent frame 1112 ..
Glazing bead 1204 ..

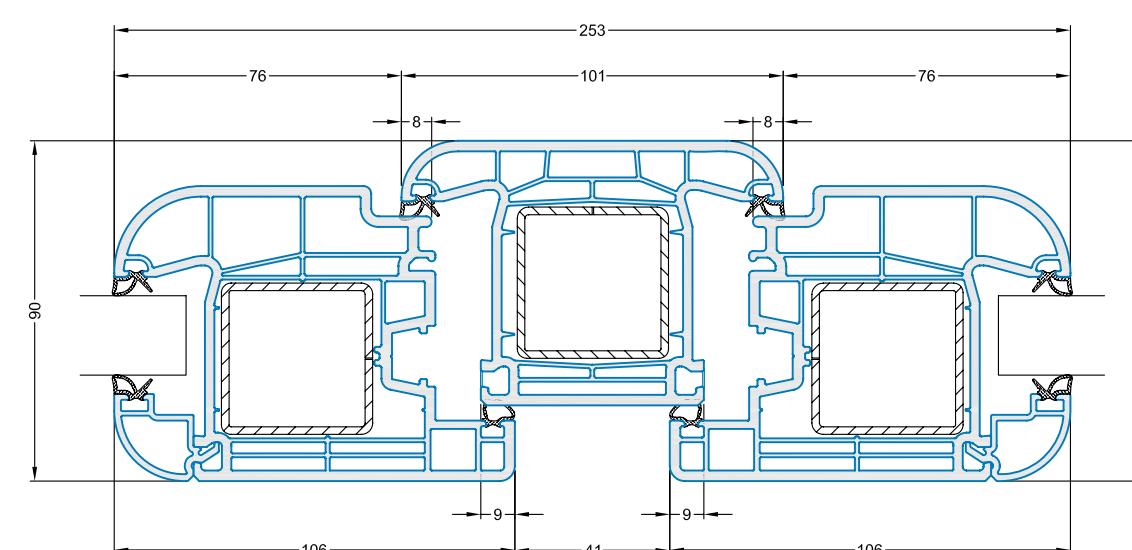

Outer frame 1116 ..
Vent frame 1114 ..
Glazing bead 1204 ..

PVC systems wingo AD • Accessory

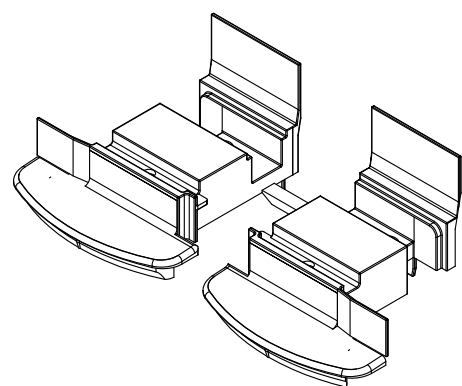

End cap for meeting stile profile large
1301 00 white
02 olive brown
06 creme (similar to RAL 9001)
07 dark brown (similar to RAL 8014)

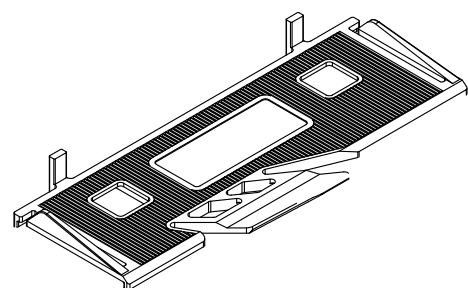

Basic block
1402 00

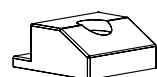

Chock
Vent frame AD and MD
7329 00

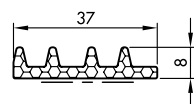

Insulation foam
1416 00

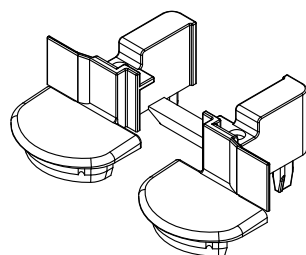

End cap for meeting stile profile small
1302 00 white
02 olive brown
06 creme (similar to RAL 9001)
07 dark brown (similar to RAL 8014)

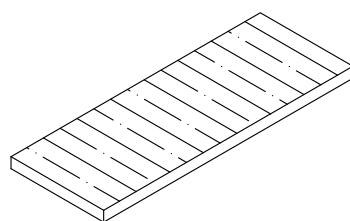

Glazing block 100 x 34 mm
1403 00 1 mm
1404 00 2 mm
1405 00 3 mm
1406 00 4 mm
1407 00 5 mm
1408 00 6 mm

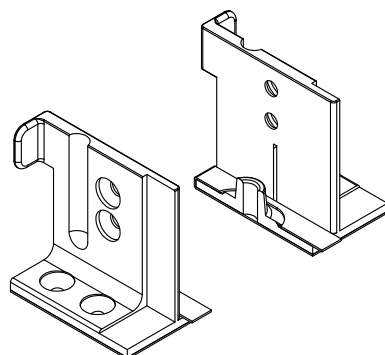

Mullion connector
1401 00

PVC systems wingo AD • Threshold

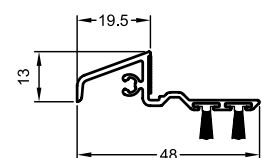

Weatherboard Aluminium
EV1 incl. Brushes
1414 00

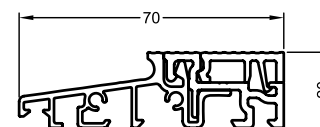

Threshold Aluminium EV1 20 / 70 mm
1413 00

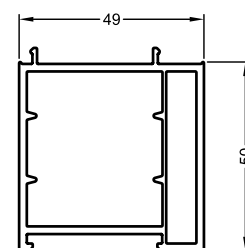

Widening 49/50 mm
Grey (Reg.)
1415 00

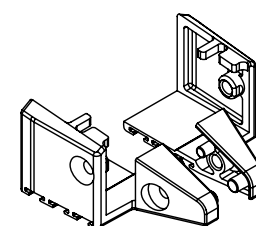

End caps weatherboard grey
1410 00

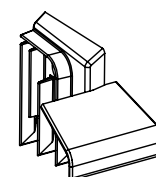

End cap for meeting stile profile
Grey left
1411 00

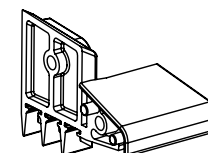

End cap for meeting stile profile
Grey right
1412 00

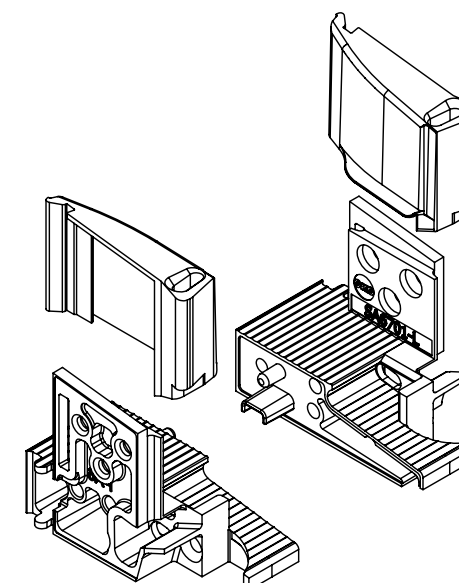
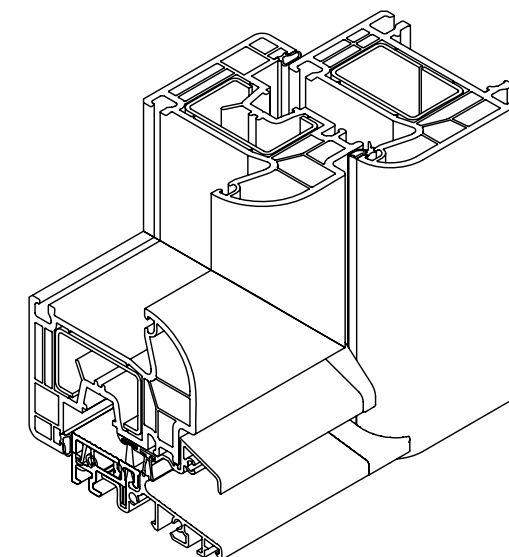
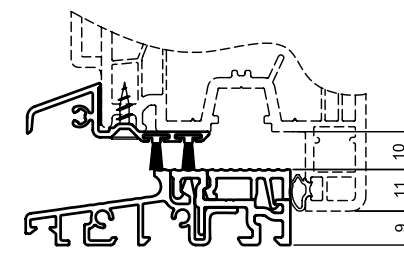

Adapter of threshold grey
With insulation foam and
threshold gasket
1409 00

PVC systems
wingo AD • Threshold

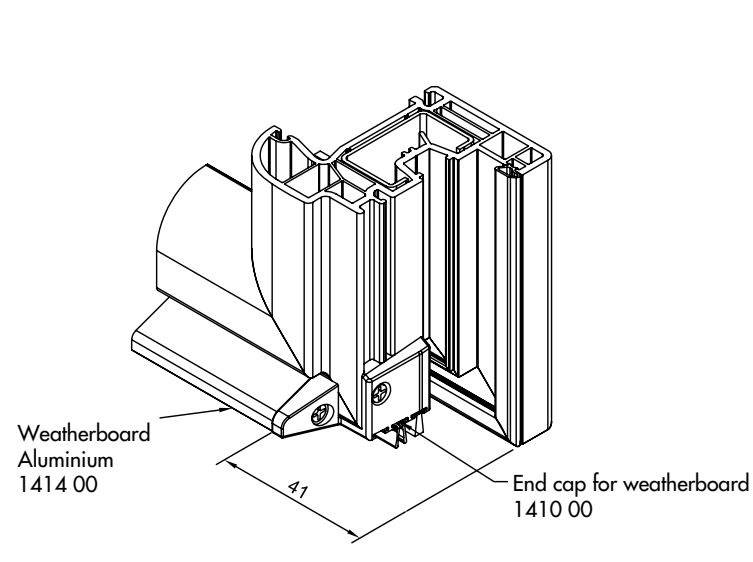
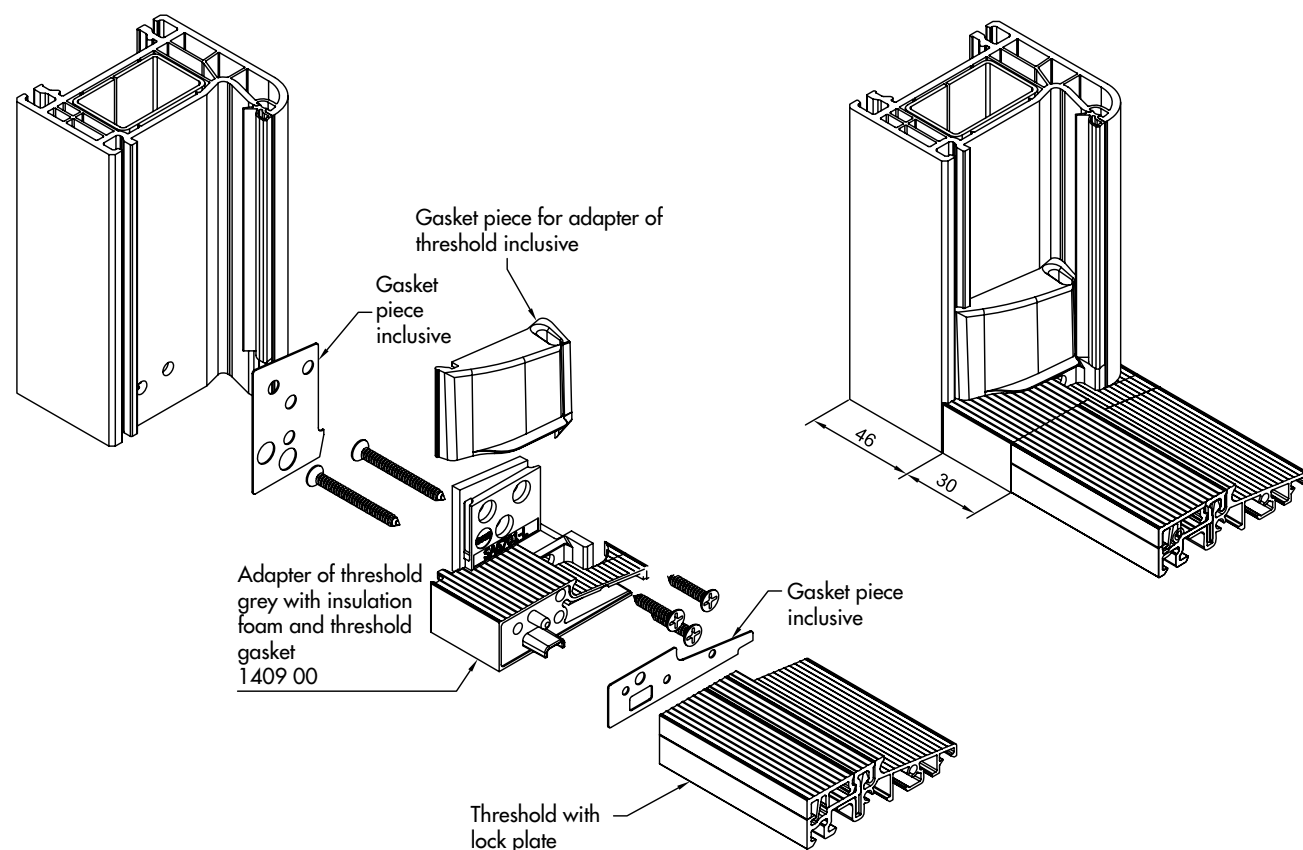

PVC systems
wingo AD • Threshold

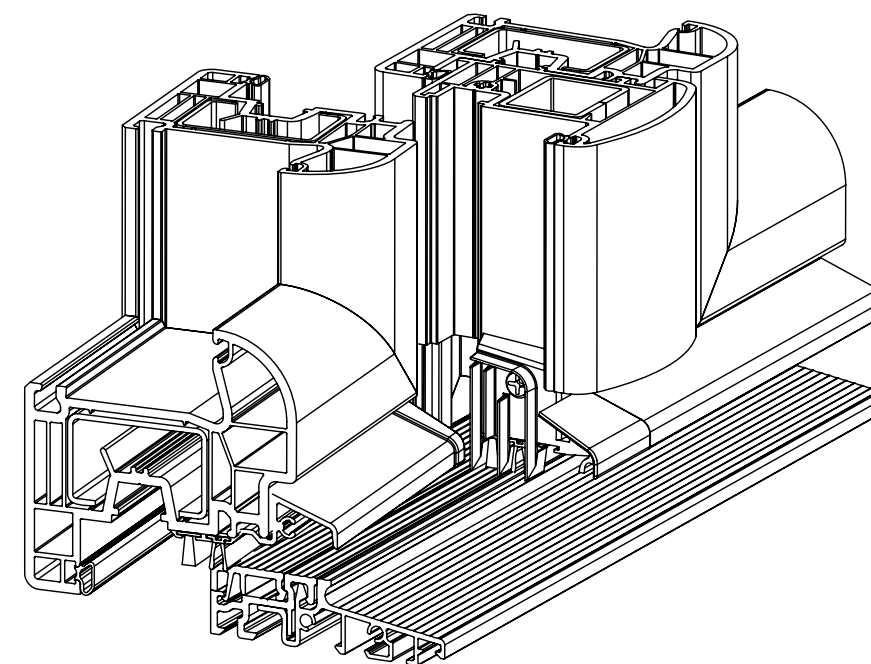
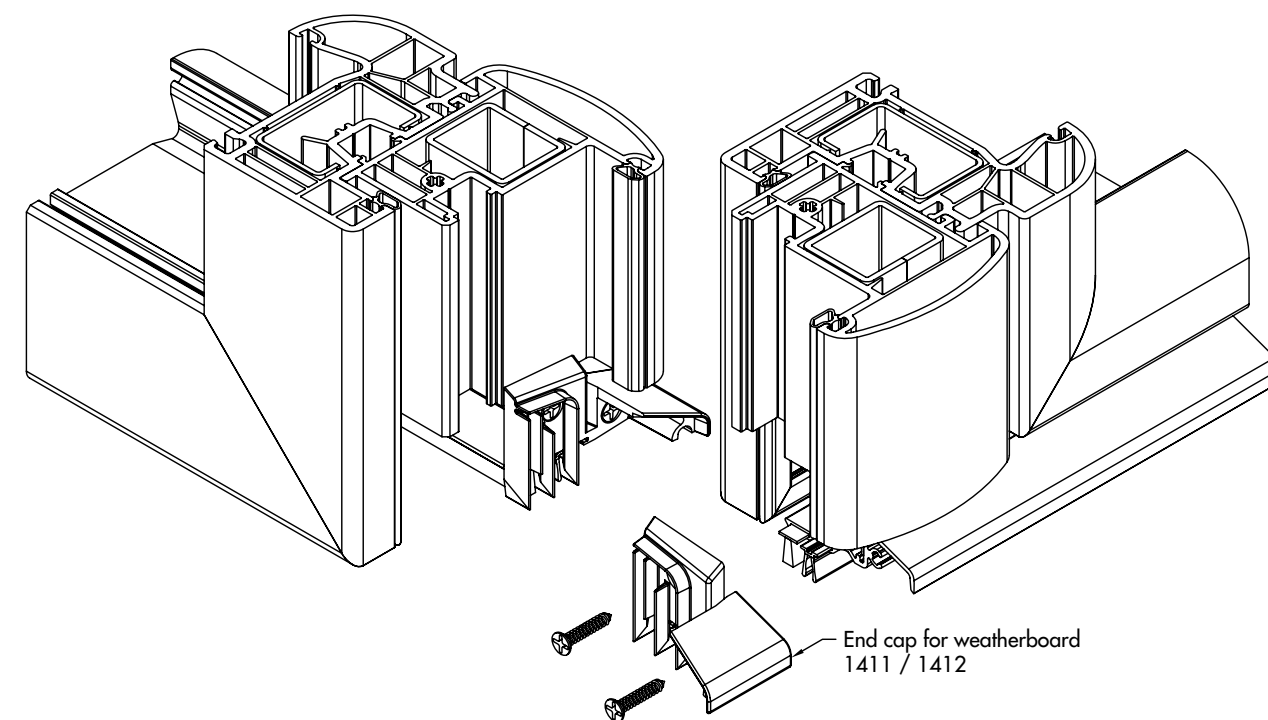

PVC systems
wingo AD • Steel reinforcements

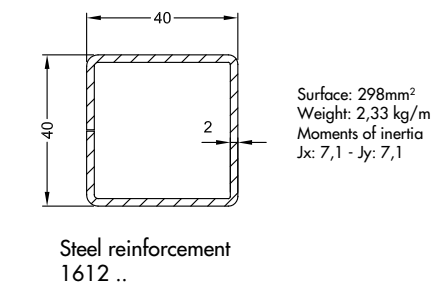
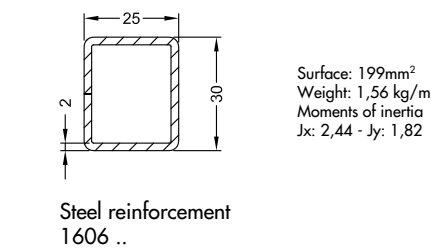
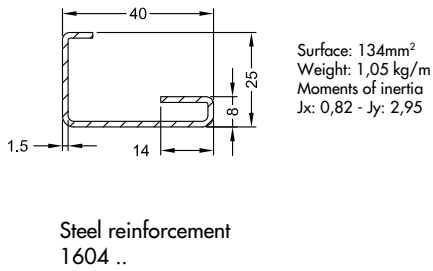
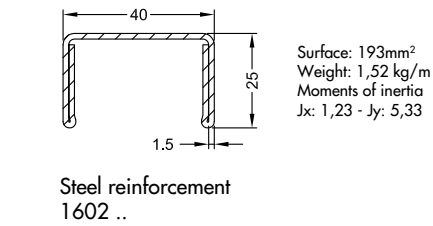
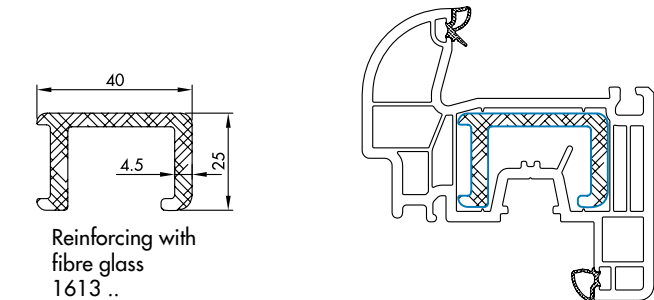
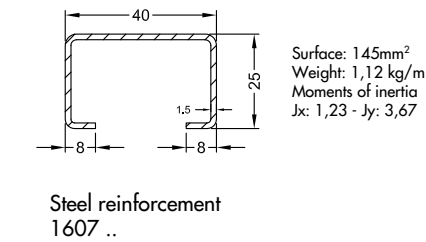
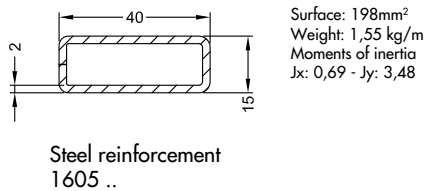
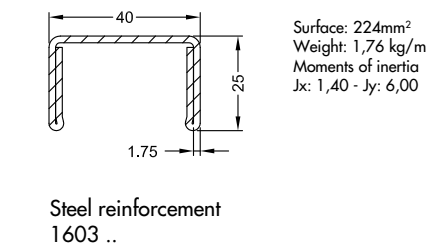
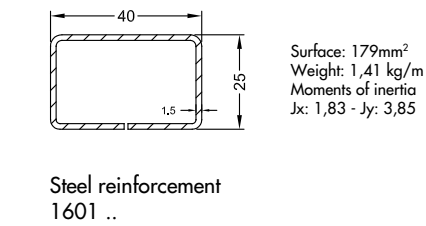

PVC systems
wingo AD • Classification of steel reinforcements

wingo AD	160 100	160 200	160 300	160 400	160 500	160 600	160 700	161 200
1101 ..								
1105 .. 1113 ..								
1106 ..								
1102 ..								
1103 ..								
1107 ..								
1108 ..								
1104 ..								
1202 ..								
1112 .. 1114 ..								
1115 ..								
1116 ..								



Sun
protection



Security



Sound
insulation

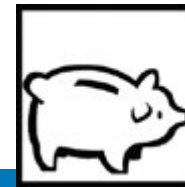

Energy
efficient



Thermal
insulation



High quality
of living

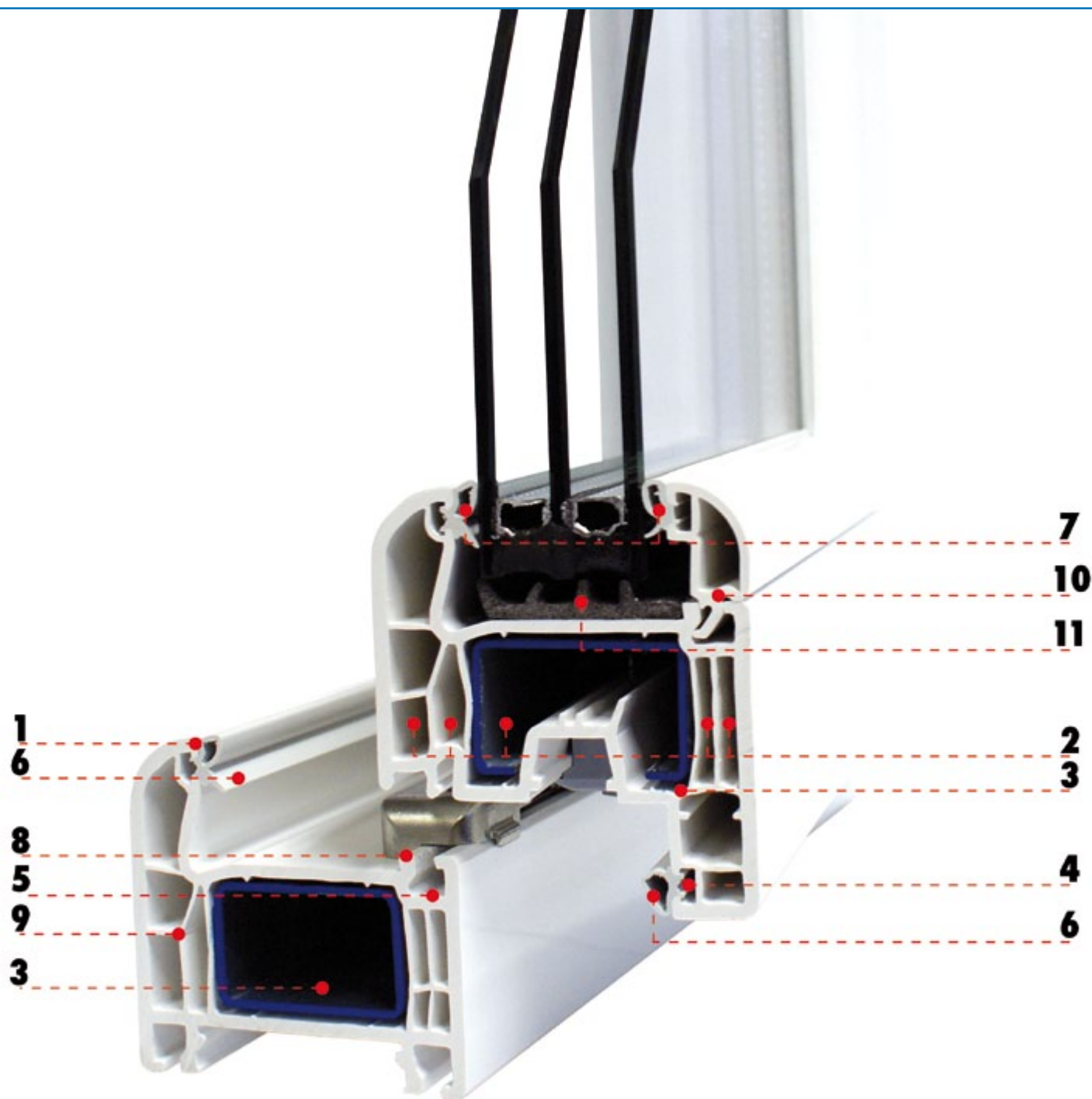

Technical data - description

1. Structured profile contour and widely rounded edges ensure a narrow exterior view and permit a maximum incidence of light.
2. The 5-chamber-system with a basic depth of 70 mm guarantees an excellent sound and thermal insulation and ensures a peaceful sleep and low heating costs.
3. Generously dimensioned profile chambers facilitate the use of galvanised stiffening of steel for extreme loading.
4. A reinforced vent frame overlap allows an easy installation of covered fittings.
5. Double fixing of the closing piece ensures a perfect protection of housebreaking.
6. All gaskets made of weatherproof elastomer are available in black as well as in papyrus white. Rounded inner edges in the frame with closed glazing beat groove avoid deposits of dirt and everything can be cleaned easily.
7. The glass gasket is rarely visible due to the new design and is also available in papyrus white.
8. The drainage and aeration of the glazing rebate in the vent frame are covered, and those of the outer frame are covered downwards or forwards.
9. The frictional fixed and easily removable glazing bead are designed for maximum wind loads and are provided with an extruded seal.
10. Perfect design with shadow gap. The gaskets are already extruded.
11. Additional thermal insulation with the VG-PE insulation.

Nachweis
Wärmedurchgangskoeffizient

Prüfbericht 422 43931/1 R1

Auftraggeber
Gargiulo GmbH
Hafenstr. 60

72131 Ofterdingen
Kunststoffprofile,
Profilkombination: Flügelrahmen-Blendrahmen

Produkt
wingo AD
Blendrahmen: 70 mm
Flügelrahmen: 78 mm

Ansichtsbild
115 mm

Material
PVC-hart

Ausführung
Stahl, verzinkt
Dicke: 32 mm
Einbauleiste: 18 mm

Besonderheiten
Polyethylen-schaumlagen im Glasfalsbereich

Grundlagen
EN ISO 10077-2: 2003-10
Wärmedurchgangskoeffizient
von Fenstern, Türen und
Abschirmungen - Berechnung des
Wärmedurchgangskoeffizienten - Teil 2: Numerische Verfahren für Rahmen
Prüfbericht 422 43931/1 vom
11. März 2010

Darstellung

Vorvermerk
Dieser Prüfbericht dient zum
Nachweis des Wärmedurchgangskoeffizienten (U_f).

Gültigkeit
Die gemessenen Daten und Ergebnisse beruhen auf der Genauigkeit der gemessenen Daten und der Genauigkeit der Messung der Wärmeübertragung durch das Bauteil.

Vorvermerk
Es gilt die Mindestanforderung an die Genauigkeit der Messung der Wärmeübertragung durch das Bauteil.

Wärmedurchgangskoeffizient
 $U_f = 1,5 \text{ W/(m}^2 \cdot \text{K)}$

if Rosenheim
14. Februar 2011

Manuel Dornel
Dipl.-Ing. (FH)
Stb. Prüfingenieur
Bauphysik

Manuel Dornel
Dipl.-Ing. (FH)
Stb. Prüfingenieur
Bauphysik

if Rosenheim GmbH
Dachstuhlstr. 1
89075 Rosenheim
Tel.: +49 (0)89 2400-0
Fax: +49 (0)89 2400-1
www.if-rosenheim.de

if Rosenheim GmbH
Dachstuhlstr. 1
89075 Rosenheim
Tel.: +49 (0)89 2400-0
Fax: +49 (0)89 2400-1
www.if-rosenheim.de

if Rosenheim GmbH
Dachstuhlstr. 1
89075 Rosenheim
Tel.: +49 (0)89 2400-0
Fax: +49 (0)89 2400-1
www.if-rosenheim.de

Nachweis
Widerstandsfähigkeit bei Windlast
Schlagregendichtheit
Luftdurchlässigkeit

Prüfbericht 10-001451-PB01-A01-02-de-01

Auftraggeber
Gargiulo GmbH
Hafenstr. 60

72131 Ofterdingen

Produkt
Einfügliges Drehkippfenster mit unterliegender Festverglasung

System
wingo AD

Außenmaß (B x H)
1474 mm x 2250 mm

Rahmenmaterial
PVC-U/weiß

Besonderheiten
-

Grundlagen
EN 14351-1: 2006-03
Prüfverfahren
EN 12206: 2000-06
EN 12217: 2000-06
EN 12211: 2000-06
EN 12244-1: 2003-11
EN 14351-1: 2006-03
Entsprechende nationale
Festigungen (DIN EN)

Darstellung

Vorvermerk
Dieser Prüfbericht dient zum
Nachweis der Widerstandsfähigkeit bei Windlast, der Schlagregendichtheit und der Luftdurchlässigkeit.
Die Ergebnisse beruhen auf der Genauigkeit der gemessenen Daten und der Genauigkeit der Messung der Widerstandsfähigkeit bei Windlast, der Schlagregendichtheit und der Luftdurchlässigkeit.

Gültigkeit
Die gemessenen Daten und Ergebnisse beruhen auf der Genauigkeit der gemessenen Daten und der Genauigkeit der Messung der Widerstandsfähigkeit bei Windlast, der Schlagregendichtheit und der Luftdurchlässigkeit.

Vorvermerk
Es gilt die Mindestanforderung an die Genauigkeit der Messung der Widerstandsfähigkeit bei Windlast, der Schlagregendichtheit und der Luftdurchlässigkeit.

Widerstandsfähigkeit bei Windlast - EN 12210
Klasse C5 / B5

Schlagregendichtheit - EN 12208
Klasse 8A

Luftdurchlässigkeit - EN 12207
Klasse 4

if Rosenheim
1. Dezember 2010

Manuel Dornel
Dipl.-Ing. (FH)
Stb. Prüfingenieur
Bauphysik

Manuel Dornel
Dipl.-Ing. (FH)
Stb. Prüfingenieur
Bauphysik

if Rosenheim GmbH
Dachstuhlstr. 1
89075 Rosenheim
Tel.: +49 (0)89 2400-0
Fax: +49 (0)89 2400-1
www.if-rosenheim.de

if Rosenheim GmbH
Dachstuhlstr. 1
89075 Rosenheim
Tel.: +49 (0)89 2400-0
Fax: +49 (0)89 2400-1
www.if-rosenheim.de

if Rosenheim GmbH
Dachstuhlstr. 1
89075 Rosenheim
Tel.: +49 (0)89 2400-0
Fax: +49 (0)89 2400-1
www.if-rosenheim.de

Nachweis
Wärmedurchgangskoeffizient

Prüfbericht
Nr. 11-001861-PR01
(PB-K20-01-de-01)

Auftraggeber
Gargiulo GmbH
Hafenstr. 60
72131 Ofterdingen
Deutschland

Produkt
Kunststoffprofil
Profilkombination: Flügelrahmen-Blendrahmen

System
wingo AD

Leistungsmerkmale
Material: Polyvinylchlorid (PVC-hart); Anstrichfarbe: RAL 9011
115; Flügelrahmen; Anstrichfarbe: RAL 9011
Ausführung: 1613; Material: Glasfaserverstärktes Polyesterharz; Einbauleiste im Glasfals; Anstrichfarbe: RAL 9011
1416; Material: Polyethylen-Weichschaum; Anstrichfarbe: RAL 9011
Ausführung: 1613; Material: Glasfaserverstärktes Polyesterharz; Einbauleiste im Glasfals; Anstrichfarbe: RAL 9011
Einbauleiste im Glasfals: 18 mm

Grundlagen
EN ISO 10077-2: 2003-10
Prüfverfahren
EN ISO 10077-2: 2003-10
Wärmedurchgangskoeffizient von Fenstern, Türen und Abschirmungen - Berechnung des Wärmedurchgangskoeffizienten - Teil 2: Numerische Verfahren für Rahmen

Darstellung

Vorvermerk
Dieser Prüfbericht dient zum Nachweis des Wärmedurchgangskoeffizienten (U_f).

Gültigkeit
Die gemessenen Daten und Ergebnisse beruhen auf der Genauigkeit der gemessenen Daten und der Genauigkeit der Messung der Wärmeübertragung durch das Bauteil.

Vorvermerk
Es gilt die Mindestanforderung an die Genauigkeit der Messung der Wärmeübertragung durch das Bauteil.

Berechnung des Wärmedurchgangskoeffizienten nach EN ISO 10077-2:2003-10
 $U_f = 1,2 \text{ W/(m}^2 \cdot \text{K)}$

if Rosenheim
19. August 2011

Manuel Dornel
Dipl.-Ing. (FH)
Stb. Prüfingenieur
Bauphysik

Manuel Dornel
Dipl.-Ing. (FH)
Stb. Prüfingenieur
Bauphysik

if Rosenheim GmbH
Dachstuhlstr. 1
89075 Rosenheim
Tel.: +49 (0)89 2400-0
Fax: +49 (0)89 2400-1
www.if-rosenheim.de

if Rosenheim GmbH
Dachstuhlstr. 1
89075 Rosenheim
Tel.: +49 (0)89 2400-0
Fax: +49 (0)89 2400-1
www.if-rosenheim.de

if Rosenheim GmbH
Dachstuhlstr. 1
89075 Rosenheim
Tel.: +49 (0)89 2400-0
Fax: +49 (0)89 2400-1
www.if-rosenheim.de

Nachweis
Wärmedurchgangskoeffizient

Prüfbericht 422 43931/1

Auftraggeber
Gargiulo GmbH
Hafenstr. 60

72131 Ofterdingen
Kunststoffprofile,
Profilkombination: Flügelrahmen-Blendrahmen

Produkt
VG 70 SK
Blendrahmen: 70 mm
Flügelrahmen: 78 mm

Ansichtsbild
115 mm

Material
PVC-hart

Ausführung
Stahl, verzinkt
Dicke: 32 mm
Einbauleiste: 18 mm

Besonderheiten
Polyethylen-schaumlagen im Glasfalsbereich

Grundlagen
EN ISO 10077-2: 2003-10
Wärmedurchgangskoeffizient
von Fenstern, Türen und
Abschirmungen - Berechnung des
Wärmedurchgangskoeffizienten - Teil 2: Numerische Verfahren für Rahmen

Darstellung

Vorvermerk
Dieser Prüfbericht dient zum
Nachweis des Wärmedurchgangskoeffizienten (U_f).

Gültigkeit
Die gemessenen Daten und Ergebnisse beruhen auf der Genauigkeit der gemessenen Daten und der Genauigkeit der Messung der Wärmeübertragung durch das Bauteil.

Vorvermerk
Es gilt die Mindestanforderung an die Genauigkeit der Messung der Wärmeübertragung durch das Bauteil.

Wärmedurchgangskoeffizient
 $U_f = 1,5 \text{ W/(m}^2 \cdot \text{K)}$

if Rosenheim
17. März 2010

Manuel Dornel
Dipl.-Ing. (FH)
Stb. Prüfingenieur
Bauphysik

Manuel Dornel
Dipl.-Ing. (FH)
Stb. Prüfingenieur
Bauphysik

if Rosenheim GmbH
Dachstuhlstr. 1
89075 Rosenheim
Tel.: +49 (0)89 2400-0
Fax: +49 (0)89 2400-1
www.if-rosenheim.de

if Rosenheim GmbH
Dachstuhlstr. 1
89075 Rosenheim
Tel.: +49 (0)89 2400-0
Fax: +49 (0)89 2400-1
www.if-rosenheim.de

if Rosenheim GmbH
Dachstuhlstr. 1
89075 Rosenheim
Tel.: +49 (0)89 2400-0
Fax: +49 (0)89 2400-1
www.if-rosenheim.de

Nachweis
Widerstandsfähigkeit bei Windlast
Schlagregendichtheit
Luftdurchlässigkeit

Prüfbericht 10-001451-PB02-A01-02-de-01

Auftraggeber
Gargiulo GmbH
Hafenstr. 60

72131 Ofterdingen

Produkt
Einfügliges Drehkippfenster

System
wingo AD

Außenmaß (B x H)
924 mm x 2174 mm

Rahmenmaterial
PVC-U/weiß

Besonderheiten
-

Grundlagen
EN 14351-1: 2006-03
Prüfverfahren
EN 12206: 2000-06
EN 12217: 2000-06
EN 12211: 2000-06
EN 12244-1: 2003-11
EN 14351-1: 2006-03
Entsprechende nationale
Festigungen (DIN EN)

Darstellung

Vorvermerk
Dieser Prüfbericht dient zum
Nachweis der Widerstandsfähigkeit bei Windlast, der Schlagregendichtheit und der Luftdurchlässigkeit.
Die Ergebnisse beruhen auf der Genauigkeit der gemessenen Daten und der Genauigkeit der Messung der Widerstandsfähigkeit bei Windlast, der Schlagregendichtheit und der Luftdurchlässigkeit.

Gültigkeit
Die gemessenen Daten und Ergebnisse beruhen auf der Genauigkeit der gemessenen Daten und der Genauigkeit der Messung der Widerstandsfähigkeit bei Windlast, der Schlagregendichtheit und der Luftdurchlässigkeit.

Vorvermerk
Es gilt die Mindestanforderung an die Genauigkeit der Messung der Widerstandsfähigkeit bei Windlast, der Schlagregendichtheit und der Luftdurchlässigkeit.

Widerstandsfähigkeit bei Windlast - EN 12210
Klasse C3 / B3

Schlagregendichtheit - EN 12208
Klasse E 900

Luftdurchlässigkeit - EN 12207
Klasse 4

if Rosenheim
7. Dezember 2010

Manuel Dornel
Dipl.-Ing. (FH)
Stb. Prüfingenieur
Bauphysik

Manuel Dornel
Dipl.-Ing. (FH)
Stb. Prüfingenieur
Bauphysik

if Rosenheim GmbH
Dachstuhlstr. 1
89075 Rosenheim
Tel.: +49 (0)89 2400-0
Fax: +49 (0)89 2400-1
www.if-rosenheim.de

if Rosenheim GmbH
Dachstuhlstr. 1
89075 Rosenheim
Tel.: +49 (0)89 2400-0
Fax: +49 (0)89 2400-1
www.if-rosenheim.de

if Rosenheim GmbH
Dachstuhlstr. 1
89075 Rosenheim
Tel.: +49 (0)89 2400-0
Fax: +49 (0)89 2400-1
www.if-rosenheim.de

Nachweis
Widerstandsfähigkeit bei Windlast
Schlagregendichtheit
Luftdurchlässigkeit

Prüfbericht 10-001451-PB03-A01-02-de-01

Auftraggeber
Gargiulo GmbH
Hafenstr. 60

72131 Ofterdingen

Produkt
Zweifügliges Drehkippfenster mit offenbarem Mittelstück

System
wingo AD

Außenmaß (B x H)
2300 mm x 1450 mm

Rahmenmaterial
PVC-U/weiß

Besonderheiten
-

Grundlagen
EN 14351-1: 2006-03
Prüfverfahren
EN 12206: 2000-06
EN 12217: 2000-06
EN 12211: 2000-06
EN 12244-1: 2003-11
EN 14351-1: 2006-03
Entsprechende nationale
Festigungen (DIN EN)

Darstellung

Vorvermerk
Dieser Prüfbericht dient zum
Nachweis der Widerstandsfähigkeit bei Windlast, der Schlagregendichtheit und der Luftdurchlässigkeit.
Die Ergebnisse beruhen auf der Genauigkeit der gemessenen Daten und der Genauigkeit der Messung der Widerstandsfähigkeit bei Windlast, der Schlagregendichtheit und der Luftdurchlässigkeit.

Gültigkeit
Die gemessenen Daten und Ergebnisse beruhen auf der Genauigkeit der gemessenen Daten und der Genauigkeit der Messung der Widerstandsfähigkeit bei Windlast, der Schlagregendichtheit und der Luftdurchlässigkeit.

Vorvermerk
Es gilt die Mindestanforderung an die Genauigkeit der Messung der Widerstandsfähigkeit bei Windlast, der Schlagregendichtheit und der Luftdurchlässigkeit.

Widerstandsfähigkeit bei Windlast - EN 12210
Klasse C3 / B3

Schlagregendichtheit - EN 12208
Klasse 9A

Luftdurchlässigkeit - EN 12207
Klasse 4

if Rosenheim
7. Dezember 2010

Manuel Dornel
Dipl.-Ing. (FH)
Stb. Prüfingenieur
Bauphysik

Manuel Dornel
Dipl.-Ing. (FH)
Stb. Prüfingenieur
Bauphysik

if Rosenheim GmbH
Dachstuhlstr. 1
89075 Rosenheim
Tel.: +49 (0)89 2400-0
Fax: +49 (0)89 2400-1
www.if-rosenheim.de

if Rosenheim GmbH
Dachstuhlstr. 1
89075 Rosenheim
Tel.: +49 (0)89 2400-0
Fax: +49 (0)89 2400-1
www.if-rosenheim.de

if Rosenheim GmbH
Dachstuhlstr. 1
89075 Rosenheim
Tel.: +49 (0)89 2400-0
Fax: +49 (0)89 2400-1
www.if-rosenheim.de

Guarantee certificate



The company GARGIULO GmbH grants:

1. A guarantee of 10 years from the date of manufacture on the white wingo profiles made out of impact resistant hard PVC
2. 7 years from the date of manufacture on the laminated profiles utilised in Central Europea, and 5 years utilized in the Southern Europe.
3. 3 years on the products which are not produced in the company GARIGULO GmbH

The warranty refers to:

- lighth fastness (colour deviation not more than the 3. level of greyscale)
- resistance to lyes, acids and fats.
(Table of resistance of Saechling)
- equability of the measures within the permitted tolerance of DIN 7748, DIN 16969 and DIN 54001, as well as the quality and inspection specifications for PVC windows according to RAL-RG 716/1.

Excluded out of the warranty are: changes of colour of the material, which was not treated properly during the mounting as well as improper storage, handling errors, incorrect packing, incorrect care, irresistible force and errors which are caused by intervention of the consumer or third party.

Excluded are also colour changes which are caused by media, which are not listed in the quality and inspection specifications.

Claims under guarantee can only be accepted if the defect will be shown immediately after observation

The guarantee replacement refers exclusively to the value of the criticised profiles

Offerdingen - May 2010

CEO GARGIULO GmbH

Vincenzo Gargiulo



SYSTEM Alpsteg SWISS MD programme

Alpsteg SWISS MD is a profile system, that fulfills absolutely the high requirements of optics, static, sound and thermal insulation. Excellent technology and security with an exact basic depth of 70 mm. This window system is very suitable in old as well as in new buildings and meets the highest expectations of a Swiss client.



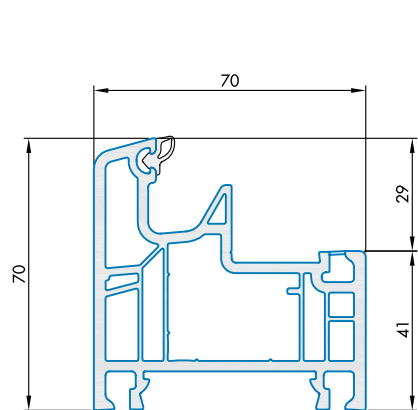

Outer frame MD 70
7101 ..

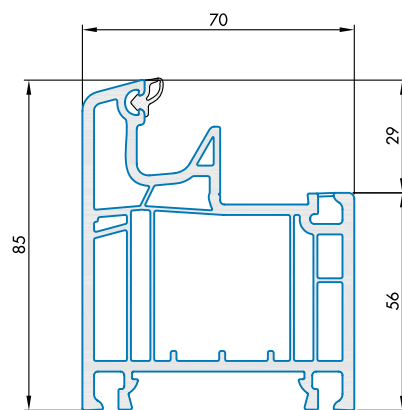

Outer frame MD 85
7102 ..

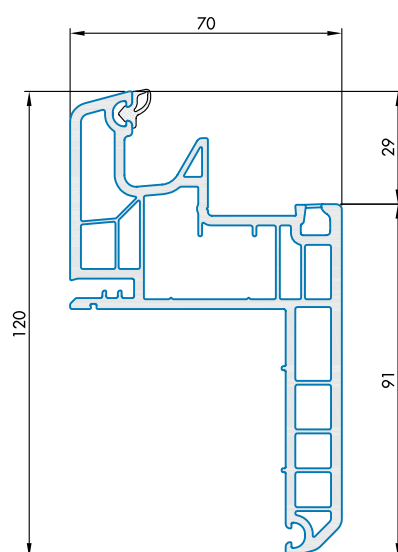

Outer frame renovation
7133 ..

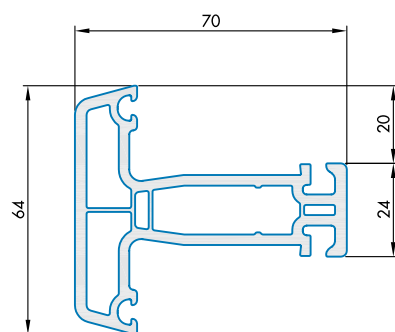

Mullion 64
7115 ..

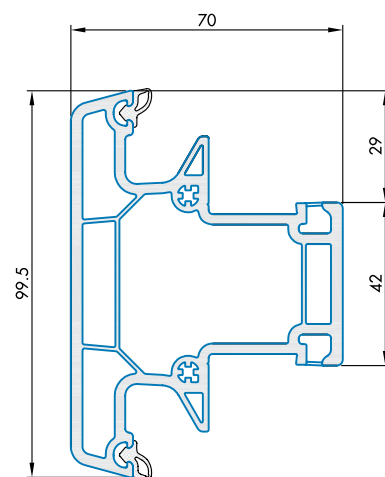

Mullion 100
7114 ..

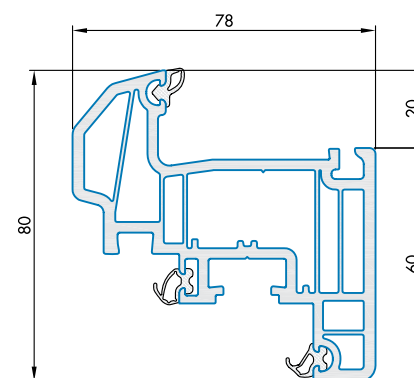

Vent frame semi-flush/ m
7109 ..

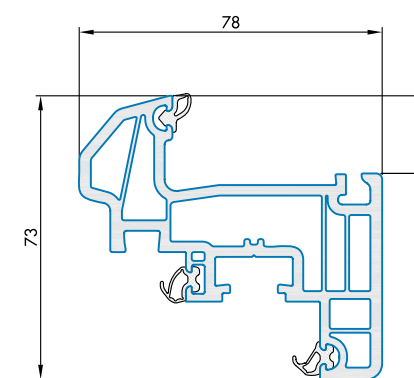

Vent frame semi-flush/ s
7108 ..

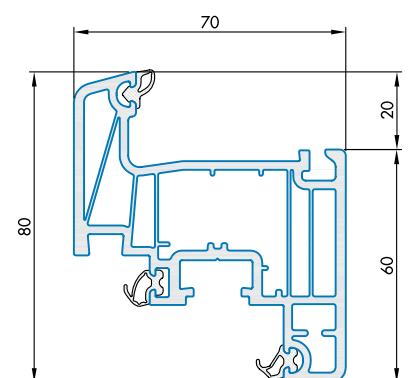

Vent frame rebated
7193 ..

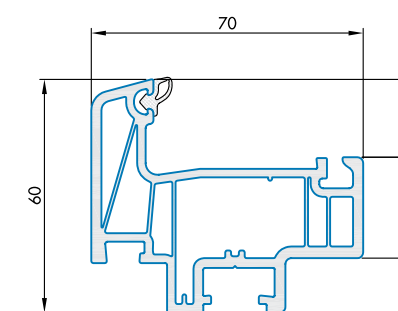

Meeting stile profile rebated
7194 ..

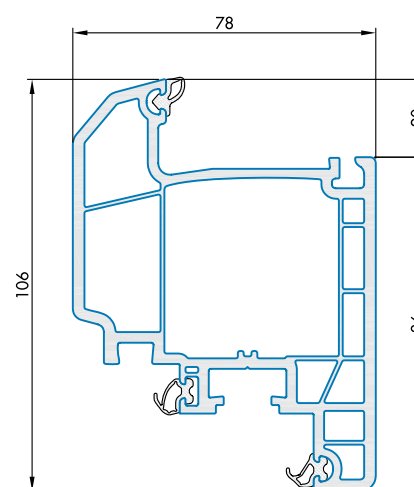

French window to open inward
7106 ..

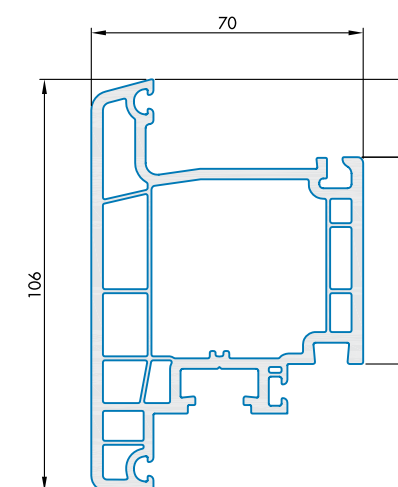

French window to open outward
7107 ..

PVC systems
Alpsteg SWISS MD • Combinations

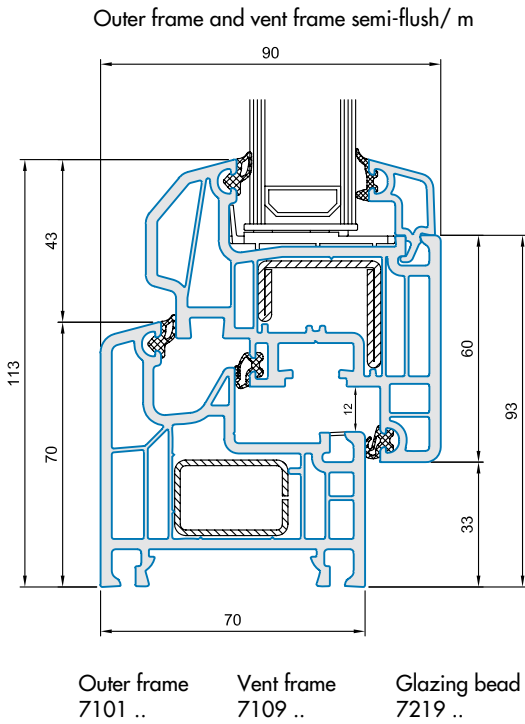
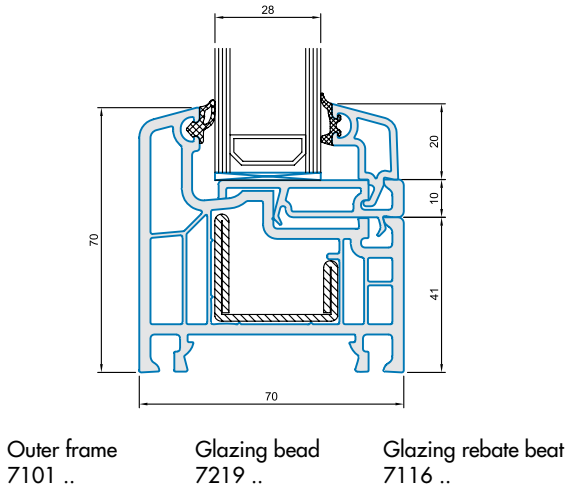

PVC systems
Alpsteg SWISS MD • Combinations

Vent frame semi-flush/ s
with meeting stile profile

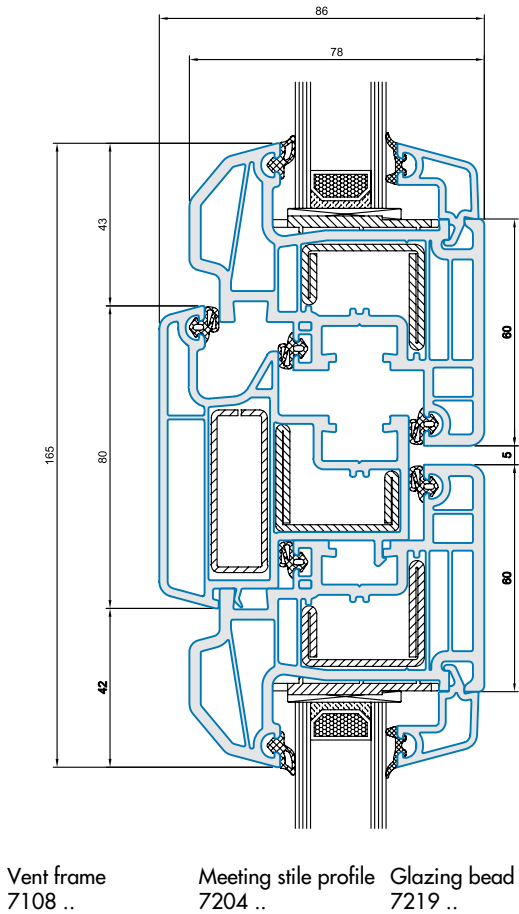
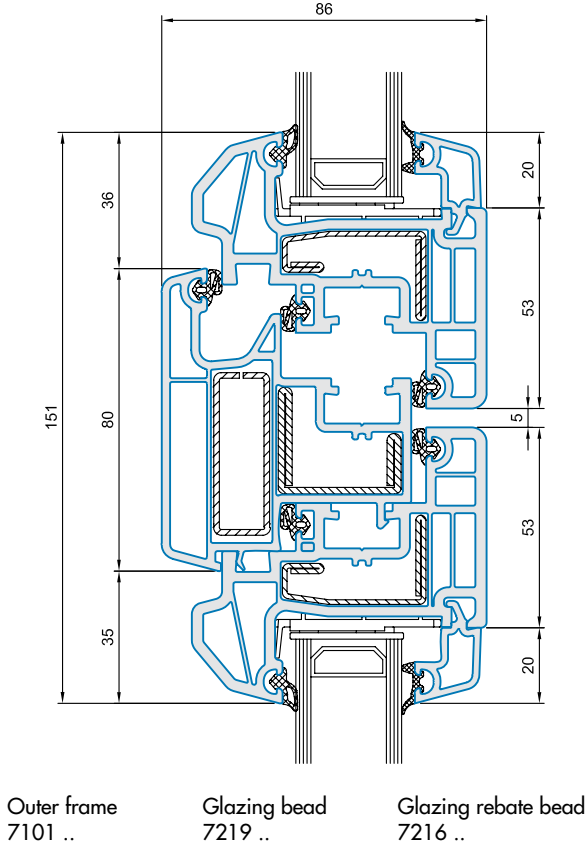

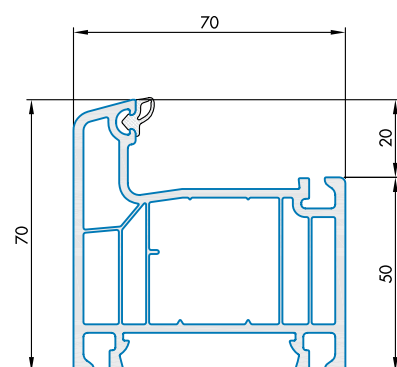

Outer frame ECO 70
7191 ..

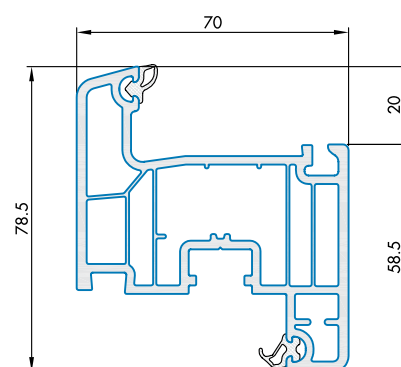

Vent frame rebated/m ECO 70
7192 ..

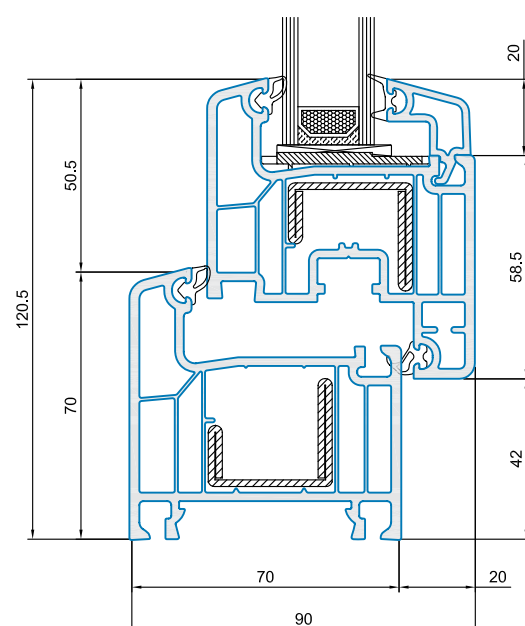

Steels
7622 .., 7624 ..

Alternative: 30 x 30 x 1,5 mm

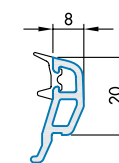

Glazing rebate bead 8mm
glass 40mm
7230 ..

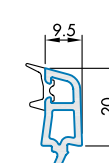

Glazing rebate bead 9,5mm
glass 36mm
7217 ..

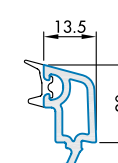

Glazing rebate bead 13,5mm
glass 32mm
7218 ..

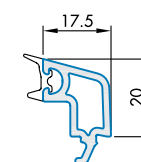

Glazing rebate bead 17,5mm
glass 28mm
7219 ..

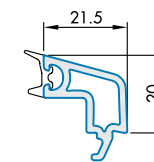

Glazing rebate bead 21,5mm
glass 24mm
7220 ..

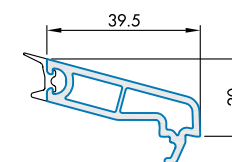

Glazing rebate bead 39,5mm
glass 6mm
7221 ..

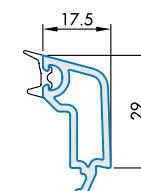

Glazing rebate bead 17,5mm fix
glass 28mm fix
7222 ..

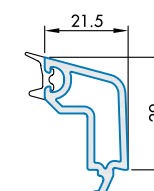

Glazing rebate bead 21,5mm fix
glass 24mm fix
7223 ..

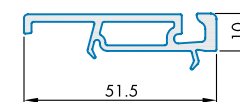

Glazing rebate bead
7216 ..

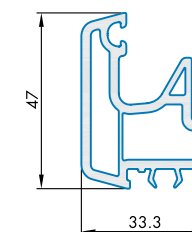

Meeting stile profile 47
7205 ..

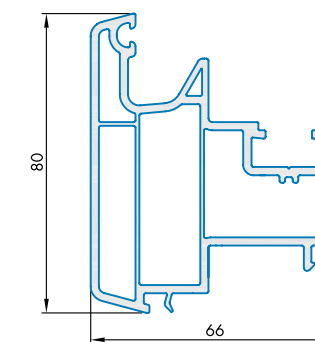

Meeting stile profile 80
7204 ..

PVC systems General secondary profiles

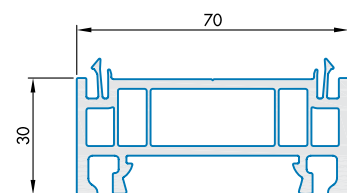

Extension profile 30 mm
7212 ..

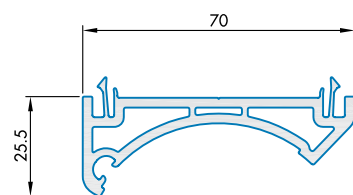

Corner profile variable
7210 ..

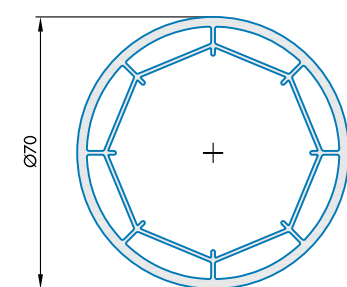

PVC-U tube
7297 ..

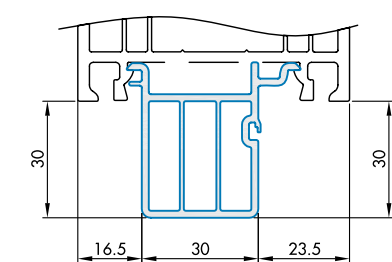

Window sill connection profile
7275 00

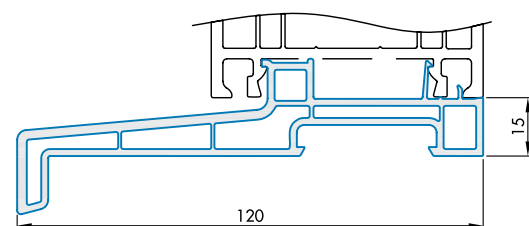

Window sill profile 120x15
7515 ..

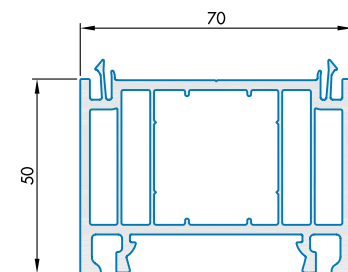

Extension profile 50 mm
7213 ..

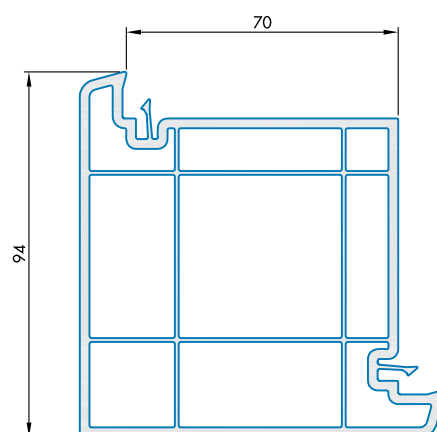

Corner profile 90°
7207 ..

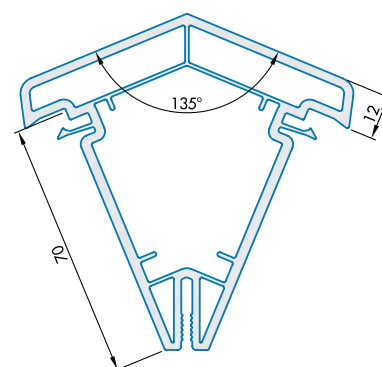

Corner profile 135°
7208 ..

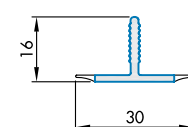

T-profile
7209 ..

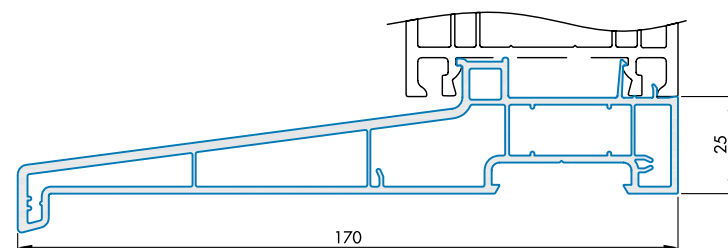

Window sill profile 170x25
7516 ..

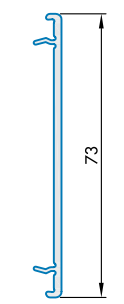

Cover profile
7288 ..

PVC systems General secondary profiles

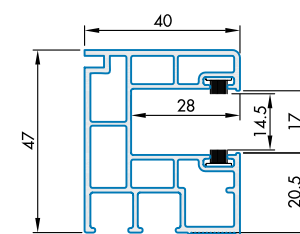

Guide bar of roller shutter
930 B2

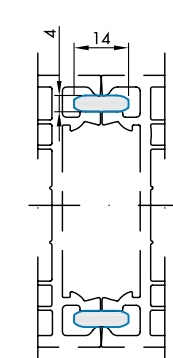

Connecting piece
7236 ..

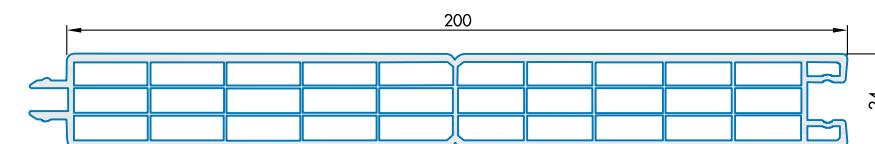

Panel
030 ..

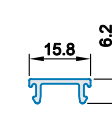

Cover strip
7235 ..

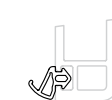

Rebate gasket EPDM
7602 00 black
7602 04 papyrus white

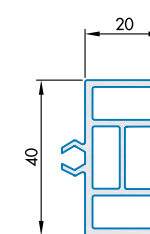

Duplication
Guide bar of roller shutter
930

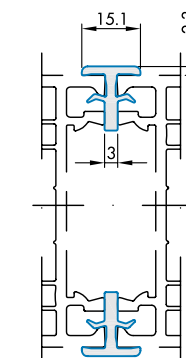

Connecting piece
7225 ..

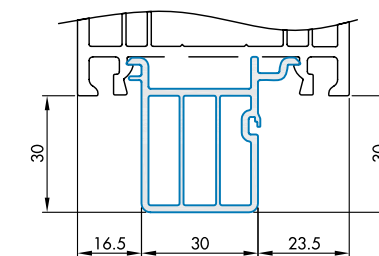

Connection profile of window sill
7275 00

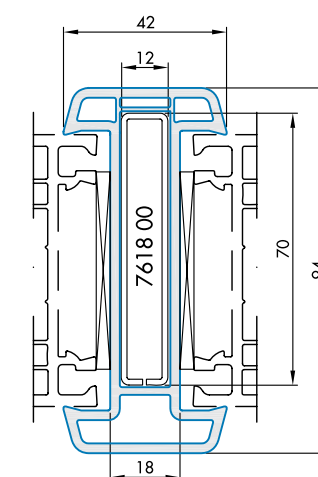

Frame coupling
7270 ..

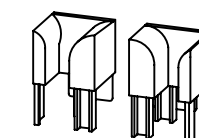

Hopper for 930 B2
932 white
932 B brown



Glass gasket EPDM
2609 00 black
2609 04 papyrus white

General secondary profiles

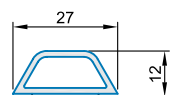

Glazing beat 27 R4
7239 ..

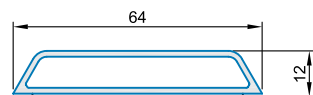

Glazing beat 64 R4
7241 ..

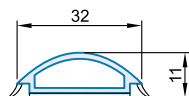

Glazing beat round
078657

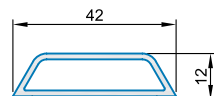

Glazing beat 42 R4
7240 ..

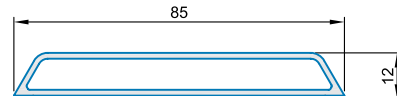

Glazing beat 85 R4
7242 ..

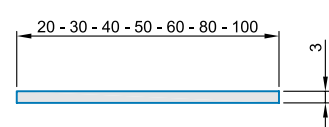

Flat section
20/3 1205 ..
30/3 1206 ..
40/3 1207 ..
50/3 1208 ..
60/3 1209 ..
80/3 1210 ..
100/3 1213 ..

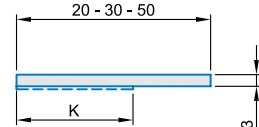

Flat section
with adhesive type
20/3 K12 078199
30/3 K19 078201
40/3 K30 078207
50/3 K30 078203

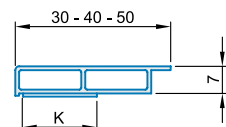

Chamber profile
with adhesive type
30/7 K15 078243
40/7 K19 078244
50/7 K19 078246

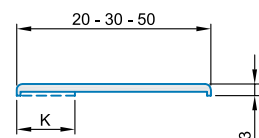

Flat section
with adhesive type
20/3 K12 078120
30/3 K15 078130
40/3 K15 078140
50/3 K15 078150
60/3 K15 078160

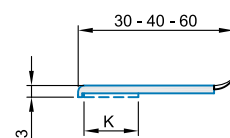

Flat section
with lip and adhesive type
30/3 K15 078201 WL
40/3 K15 078207 WL
60/3 K19 078208 WL

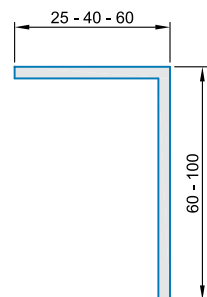

Angular profile
60/40/3 546 ..
60/60/3 547 ..
60/25/2 550 ..
100/60/3 561 ..

Alpsteg SWISS MD • Accessory

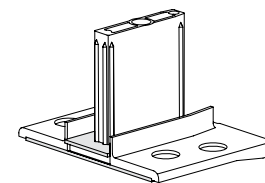

Connector without fixation cam
Mullion AD 64
7435 00

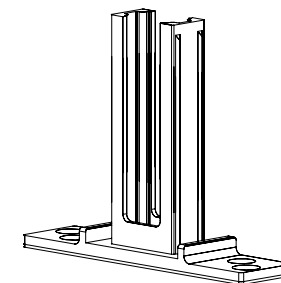

Connector without fixation cam
Mullion MD 100
7437 00

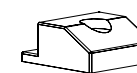

Chock
Vent frame AD and MD
7329 00

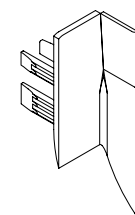

Cap for meeting stile profile MD
(pair for above / bottom)
7344 00 white
7344 02 olive brown

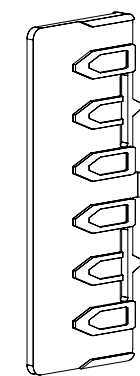

Glass bridge AD
7314 00

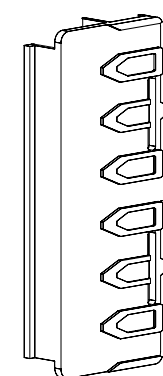

Glass bridge AD
7309 00

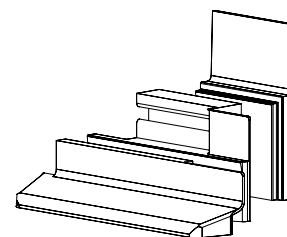

End cap for meeting stile profile MD 80
7301 00 white
7301 02 olive brown

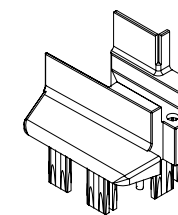

End cap for meeting stile profile MD 47
(pair for above / bottom)
7316 00 white
7316 02 olive brown

PVC systems
Alpsteg SWISS MD • Steel reinforcements

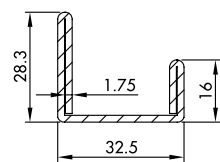

Reinforcement 28,5 / 32,5 / 16
s = 1,75 mm
7624 00

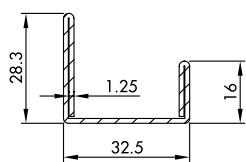

Reinforcement 28,5 / 32,5
s = 1,25 mm
7622 00

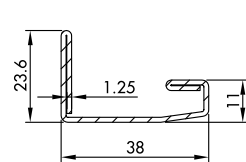

Reinforcement 23,5 / 38 / 11 / 1,25
7623 00

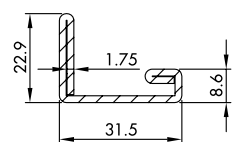

Forming tube 31,5 / 22,9 / 1,75
7646 00

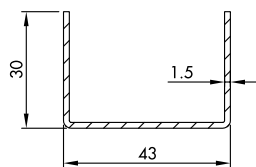

Reinforcement 43 / 30 / 1,5
7620 00

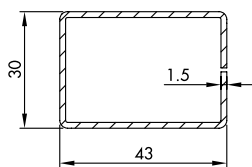

Reinforcement 43 / 30 / 1,5
7615 00

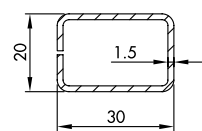

Forming tube 20 / 30 / 1,5
7627 00

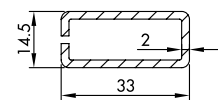

Forming tube 33 / 14,5 / 2
2602 00

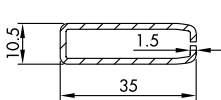

Reinforcement 35 / 10,5 / 1,5
7642 00

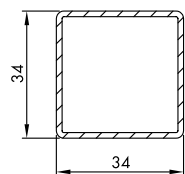

Forming tube 34 / 34 / 1,5
7626 00

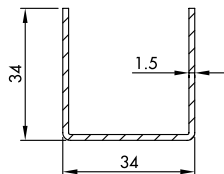

Reinforcement 34 / 34 / 1,5
7630 00

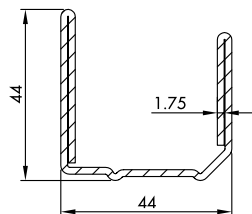

Reinforcement 44 / 44 / 1,75
7645 00

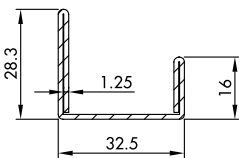

Reinforcement 7622

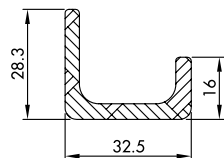

Reinforcement out
of fibre glass
7622 GFK

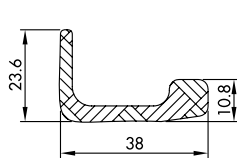

Reinforcement out
of fibre glass
7623 GFK

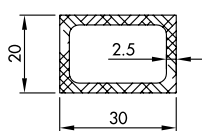

Tube out of fibre glass
20 / 30 / 2,5
55.1000

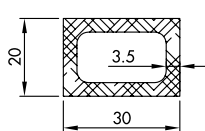

Tube out of fibre glass
20 / 30 / 3,5
55.1001

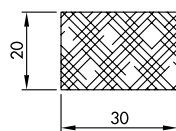

Profile filled up with fibre glass
20 / 30
55.1002

PVC systems
Alpsteg SWISS MD • Classification of steel reinforcements

Alpsteg SWISS MD														
	7615 00	7642 00	7620 00	GFK 7623	GFK 7622	7623 00	7624 00 7622 00	7626 00	7627 00	7630 00	2602 00	7645 00	7646 00	7617 00
	7102 ..													
	7113 ..													
	7108 ..													
	7130 ..													
	7109 ..													
	7131 ..													
	7193 ..													
	7194 ..													
	7106 ..													
	7107 ..													
	7114 ..													
	7115 ..													
	7204 ..													

Nachweis

Prüf- u. Klassifizierungsbericht
10-000481-PB01-A01-02-de-01

Auftraggeber: Gargiulo GmbH
Hafenstr. 60
72131 Oeffdingen

Produkt: Einflügeliges Drehkipfenster
System: System Alpteg swiss
Außenmaß (B x H): 624 mm x 2174 mm
Fahrmaterial: PVC-Weiß
Besonderheiten: -/-

Verwendungskategorie: Die ermittelten Ergebnisse können vom Hersteller als Grundlage für den Herstellerantrag zu bauaufsichtlichen Zulassungen verwendet werden. Die Festlegungen der geltenden Produktnorm sind zu beachten.

Genehmigung:  ROSENHEIM

Widerstandsfähigkeit bei Windlast – EN 12210
 Klasse C3 / B3

Schlagregendichtheit – EN 12208
 Klasse E750

Luftdurchlässigkeit – EN 12207
 Klasse 4

ift Rosenheim
25. Dezember 2019
Prof. Dr. Peter Lutz, Dipl.-Ing. (FH)
Prüfungsausschuss
Bauteile

Thomas Steiner, Dipl.-Ing. (FH)
Prüfungsausschuss
Dachstuhl & Windlast

ift Rosenheim GmbH
Rosenheimer Str. 7
85061 Rosenheim
Tel. +49 (0)89 3181-1
Fax +49 (0)89 3181-100
www.ift-rosenheim.de

ift KZG Rosenheim
Karlshausen 100
85061 Rosenheim
Tel. +49 (0)89 3181-1
Fax +49 (0)89 3181-100
www.ift-rosenheim.de

ift KZG Rosenheim
Karlshausen 100
85061 Rosenheim
Tel. +49 (0)89 3181-1
Fax +49 (0)89 3181-100
www.ift-rosenheim.de

ift KZG Rosenheim
Karlshausen 100
85061 Rosenheim
Tel. +49 (0)89 3181-1
Fax +49 (0)89 3181-100
www.ift-rosenheim.de

Nachweis

Prüf- u. Klassifizierungsbericht
10-000481-PB02-A01-02-de-01

Auftraggeber: Gargiulo GmbH
Hafenstr. 60
72131 Oeffdingen

Produkt: Einflügeliges Drehkipfenster mit unterliegender Festverglasung
System: System Alpteg swiss
Außenmaß (B x H): 1474 mm x 2250 mm
Fahrmaterial: PVC-Weiß
Besonderheiten: -/-

Verwendungskategorie: Die ermittelten Ergebnisse können vom Hersteller als Grundlage für den Herstellerantrag zu bauaufsichtlichen Zulassungen verwendet werden. Die Festlegungen der geltenden Produktnorm sind zu beachten.

Genehmigung:  ROSENHEIM

Widerstandsfähigkeit bei Windlast – EN 12210
 Klasse C3 / B3

Schlagregendichtheit – EN 12208
 Klasse E750

Luftdurchlässigkeit – EN 12207
 Klasse 4

ift Rosenheim
25. Dezember 2019
Prof. Dr. Peter Lutz, Dipl.-Ing. (FH)
Prüfungsausschuss
Bauteile

Thomas Steiner, Dipl.-Ing. (FH)
Prüfungsausschuss
Dachstuhl & Windlast

ift Rosenheim GmbH
Rosenheimer Str. 7
85061 Rosenheim
Tel. +49 (0)89 3181-1
Fax +49 (0)89 3181-100
www.ift-rosenheim.de

ift KZG Rosenheim
Karlshausen 100
85061 Rosenheim
Tel. +49 (0)89 3181-1
Fax +49 (0)89 3181-100
www.ift-rosenheim.de

ift KZG Rosenheim
Karlshausen 100
85061 Rosenheim
Tel. +49 (0)89 3181-1
Fax +49 (0)89 3181-100
www.ift-rosenheim.de

ift KZG Rosenheim
Karlshausen 100
85061 Rosenheim
Tel. +49 (0)89 3181-1
Fax +49 (0)89 3181-100
www.ift-rosenheim.de

Nachweis

Prüf- u. Klassifizierungsbericht
10-000481-PB03 A01-02-de-01

Auftraggeber: Gargiulo GmbH
Hafenstr. 60
72131 Oeffdingen

Produkt: Zweiflügeliges Dreh-Dreh-Kipp-Fenster mit aufgehenden Mittelstück
System: System Alpteg swiss
Außenmaß (B x H): 1719 mm x 2314 mm
Fahrmaterial: PVC-Weiß
Besonderheiten: -/-

Verwendungskategorie: Die ermittelten Ergebnisse können vom Hersteller als Grundlage für den Herstellerantrag zu bauaufsichtlichen Zulassungen verwendet werden. Die Festlegungen der geltenden Produktnorm sind zu beachten.

Genehmigung:  ROSENHEIM

Widerstandsfähigkeit bei Windlast – EN 12210
 Klasse C3 / B3

Schlagregendichtheit – EN 12208
 Klasse 8A

Luftdurchlässigkeit – EN 12207
 Klasse 4

ift Rosenheim
25. Dezember 2019
Prof. Dr. Peter Lutz, Dipl.-Ing. (FH)
Prüfungsausschuss
Bauteile

Thomas Steiner, Dipl.-Ing. (FH)
Prüfungsausschuss
Dachstuhl & Windlast

ift Rosenheim GmbH
Rosenheimer Str. 7
85061 Rosenheim
Tel. +49 (0)89 3181-1
Fax +49 (0)89 3181-100
www.ift-rosenheim.de

ift KZG Rosenheim
Karlshausen 100
85061 Rosenheim
Tel. +49 (0)89 3181-1
Fax +49 (0)89 3181-100
www.ift-rosenheim.de

ift KZG Rosenheim
Karlshausen 100
85061 Rosenheim
Tel. +49 (0)89 3181-1
Fax +49 (0)89 3181-100
www.ift-rosenheim.de

ift KZG Rosenheim
Karlshausen 100
85061 Rosenheim
Tel. +49 (0)89 3181-1
Fax +49 (0)89 3181-100
www.ift-rosenheim.de

SYSTEM
wingo PERFETTO

The window system wingo PERFETTO is a sliding window system and can be used for balcony doors, porch or separation element.

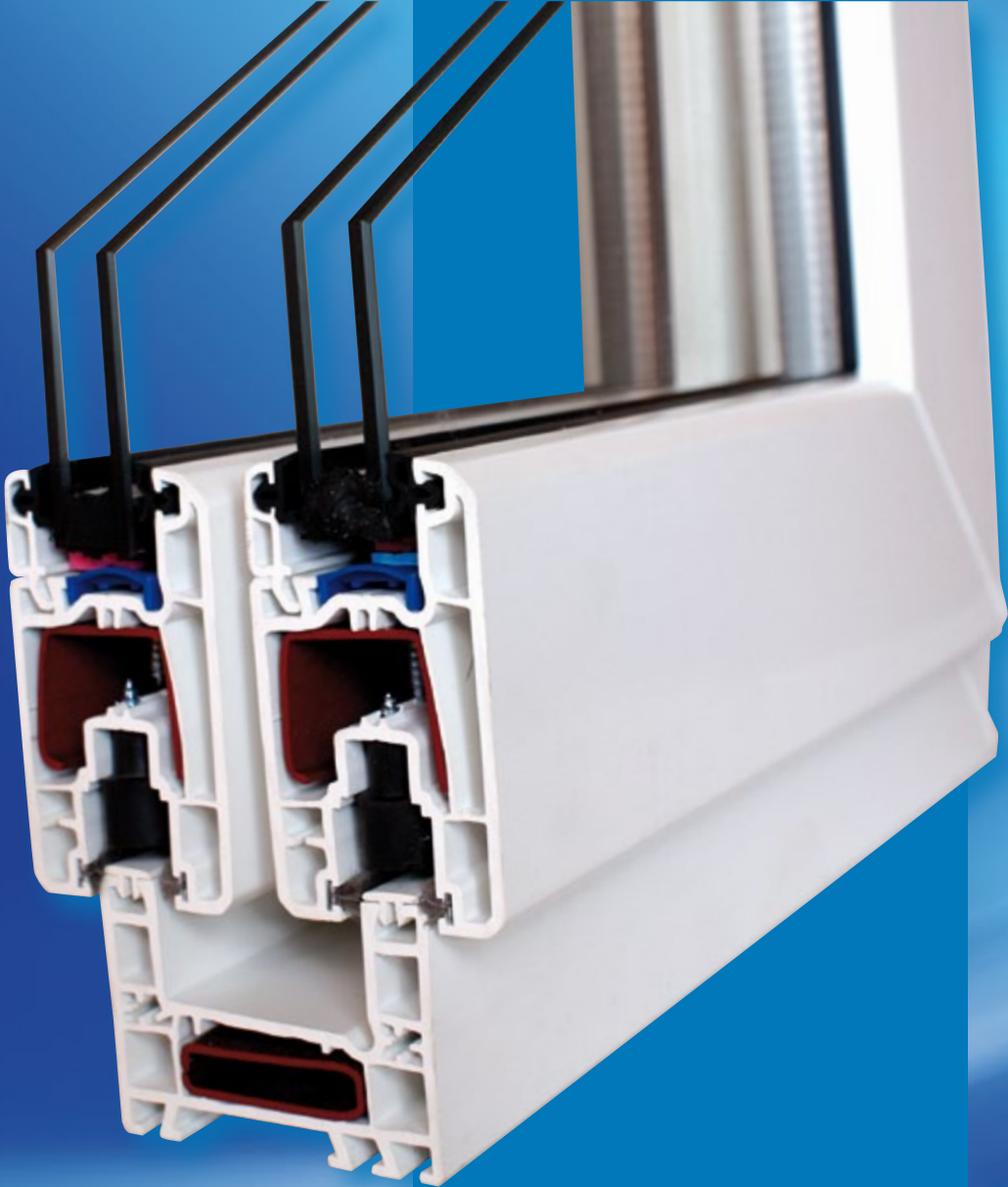

PVC systems
wingo PERFETTO • Main profiles

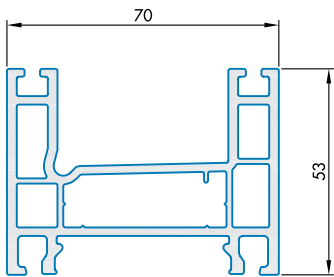

Outer frame 70/53
5101 ..

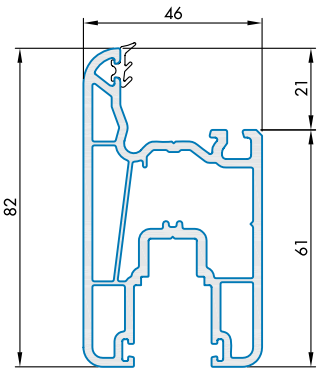

Vent frame
5102 ..

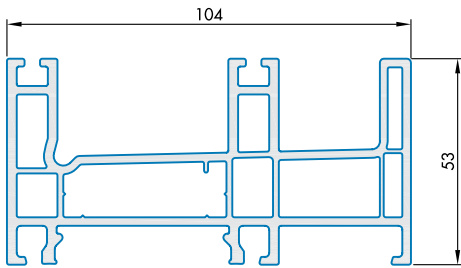

Outer frame 70/104
5103 ..

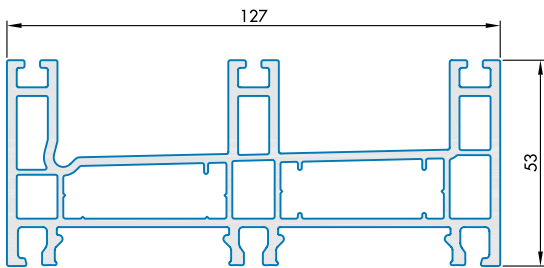

Outer frame 70/127
5104 ..

PVC systems
wingo PERFETTO • Combinations

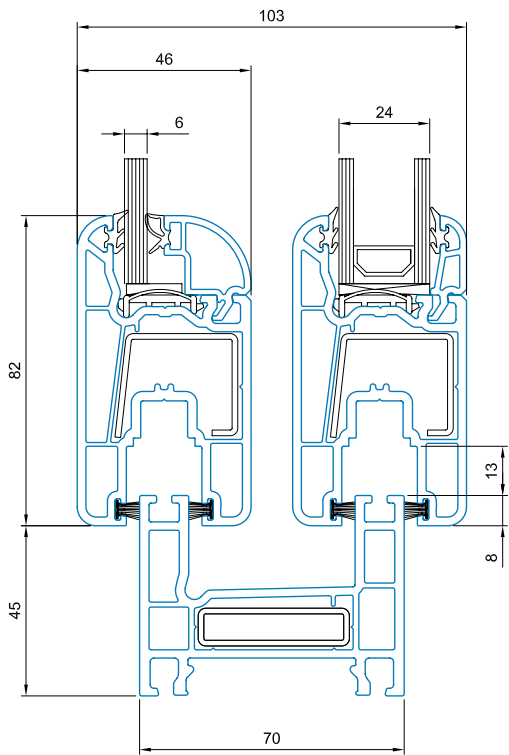

Outer frame 5101 .. Vent frame 5102 .. Glazing bead 1204 .. Glazing bead 5201 ..

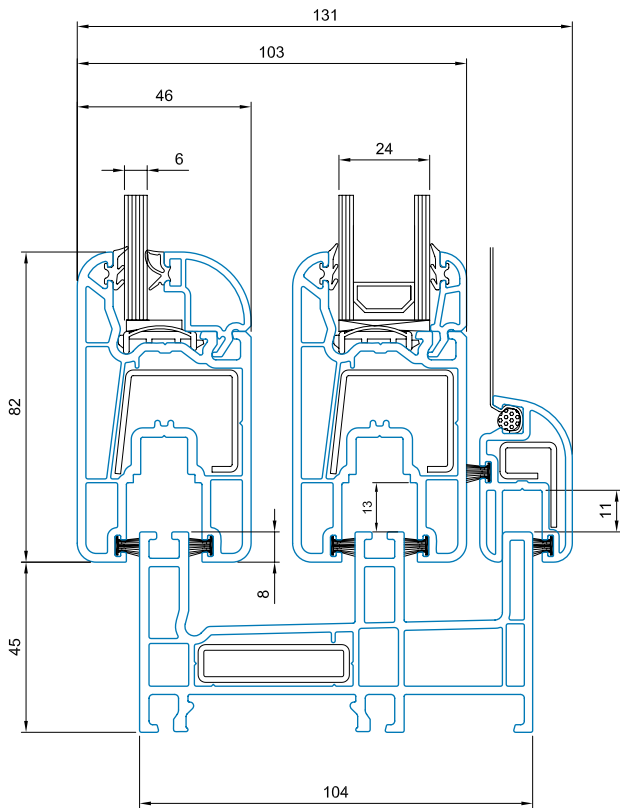

Outer frame 5103 .. Vent frame 5102 .. Glazing bead 1204 .. Glazing bead 5201 .. mosquito vent frame 5205 ..

PVC systems wingo PERFETTO • Combinations

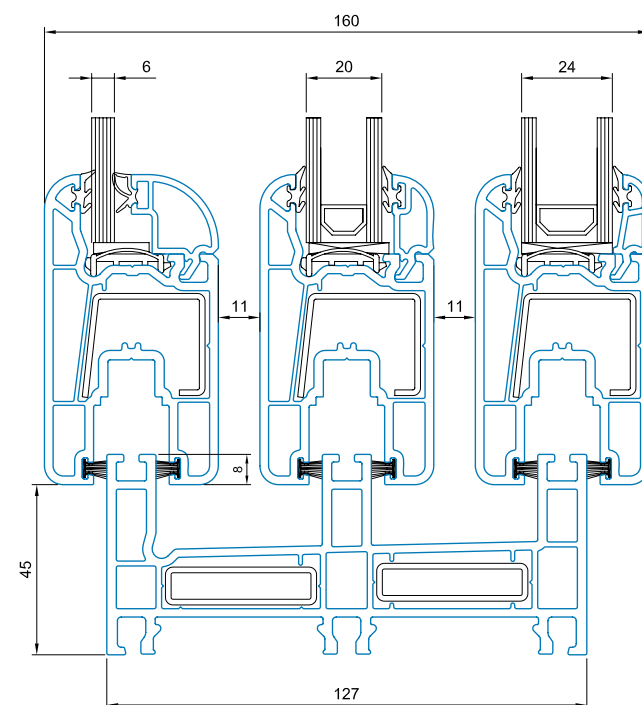

Outer frame 5104 .. Vent frame 5102 .. Glazing bead 1204 .. Glazing bead 5202 .. Glazing bead 5201 ..

PVC systems wingo PERFETTO • Additional Profiles

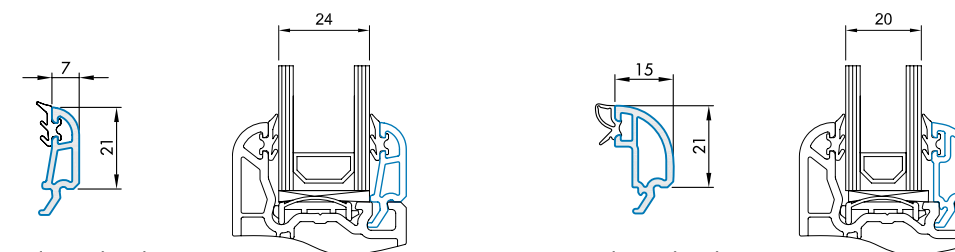

Glazing bead
7 mm
glass: 24mm
5201 ..

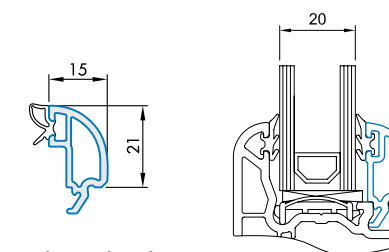

Glazing bead
glass: 14mm
1203 ..

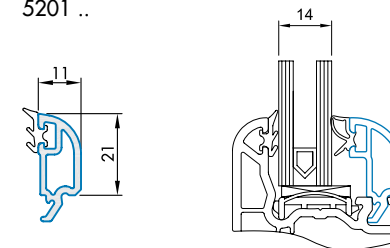

Glazing bead
11mm
glass: 20
5202 ..

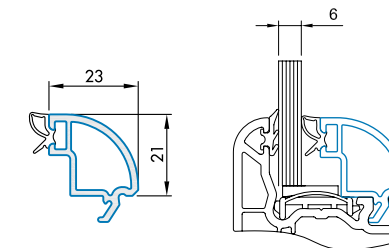

Glazing bead
glass: 6mm
1204 ..

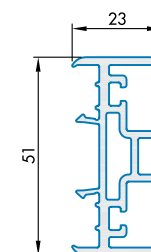

moulding for
meeting stile
5203 ..

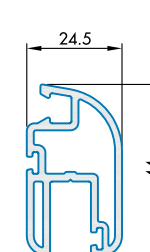

mosquito vent
frame
5205 ..

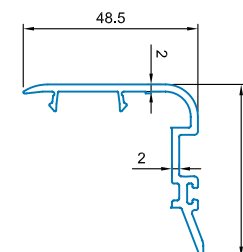

cover profile
5204 ..

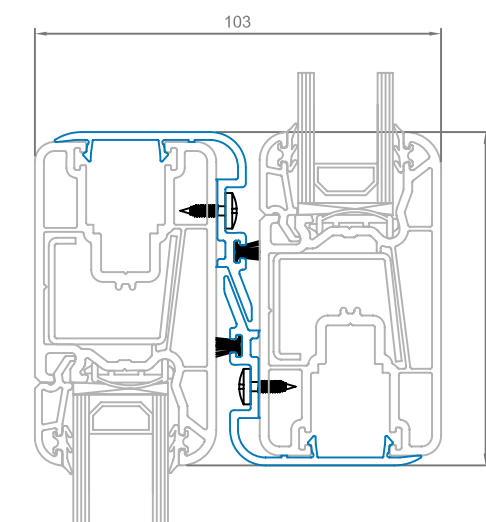

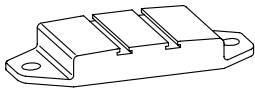

Sealing block 70er
5305 00

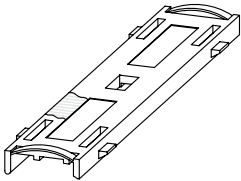

Basic block 70er
5304 00

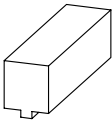

Distance block
5307 00



Sliding rail
Aluminium
5301 00



O-Ring
Cord 6mm
5302 00



Brush seal
5303 00



track roller
(mosquito)
5306 00

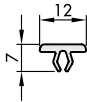

Cover profile
6215 00

Steel reinforcements

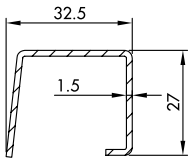

Steel vent frame
5603 00

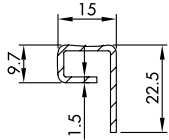

Steel mosquito
5604 00

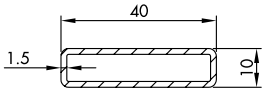

Steel outer frame
5602 00



Striker plate
5312 16

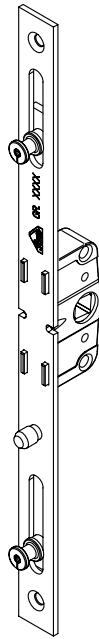

Espagnolettes
400/2 5308 16
600/2 5309 16
800/3 5310 16
1200/4 5311 16



Bogies
80 kg 5313 00
120 kg 5314 00

(The carrying capacity refers to the total weight of the vent frame with two bogies)

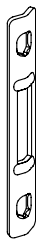

Striker plate Duo
5315 16

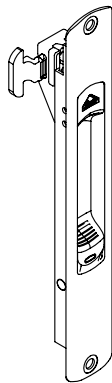

Recessed grip Duo
5616 00 white
5616 16 silver

Laminating – decorative films

GARGIULO GmbH – specialists for laminating PVC and aluminium profiles for windows and many other technological materials.

- Our staff...**
...has gained many years of experience from meeting laminating requirements. Further training is provided to our adhesive specialists on an ongoing basis to enable them to widen their know-how.
- Branded films...**
...by Renolit und Hornschuch. These films are lightfast and weatherproof and may be used both for indoor and outdoor applications along with genuine-metal films, genuine-wood films and paper films for such products as windows, doors, gates, fences, mouldings, rungs and cable channels. We are also able to coat products for the furniture, shop-fitting and automotive-profile sectors with a broad range of different patterns and designs.
- Adhesives used...**
...only RAL-approved adhesive systems based on reactive PUR hot-melt adhesives are used.



- Quality...**
...complete tracking processes using signatures applied by highly modern inkjet printers. Additional quality tests will guarantee the laminating process and ensure that highest quality standards are met.
- Full-Service...**
...such services as fitting gasket and the application of self-adhesive tapes, ready-for-sale packaging, drilling, sawing and punching. Own tool and machine construction: everything's possible!
- Materials that may be finished...**
...PVC, aluminium, wood and such wood materials as wood fibre and wood plastic composites (WPC), polystyrene and many others on inquiry!



- Which products...**
...simply stated: everything that's long and straight, e.g. window profiles and profiles for the construction sector.
- High-end laminating...**
...with rebate base three-sided laminating, which at last makes honest products out of PVC windows. The laminating on all visible surfaces presents a much higher quality appearance particularly when customers stand in front of the windows. This technology turns normal PVC windows into very exclusive premium products! A genuine added value for your window profiles. Combined with a beautiful latest-generation wood finish in a fine and matt-shimmering look – noble and not to be (s)topped.
- Logistics...**
...our forwarding partner, who works quickly and reliably throughout Europe, is located very close by. Our collection and delivery service is also available to you on request.

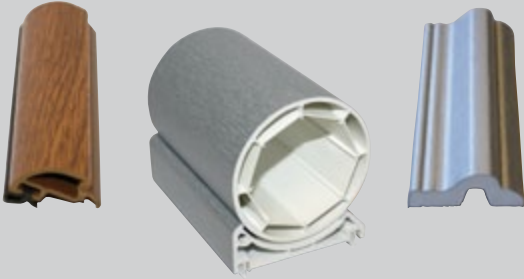
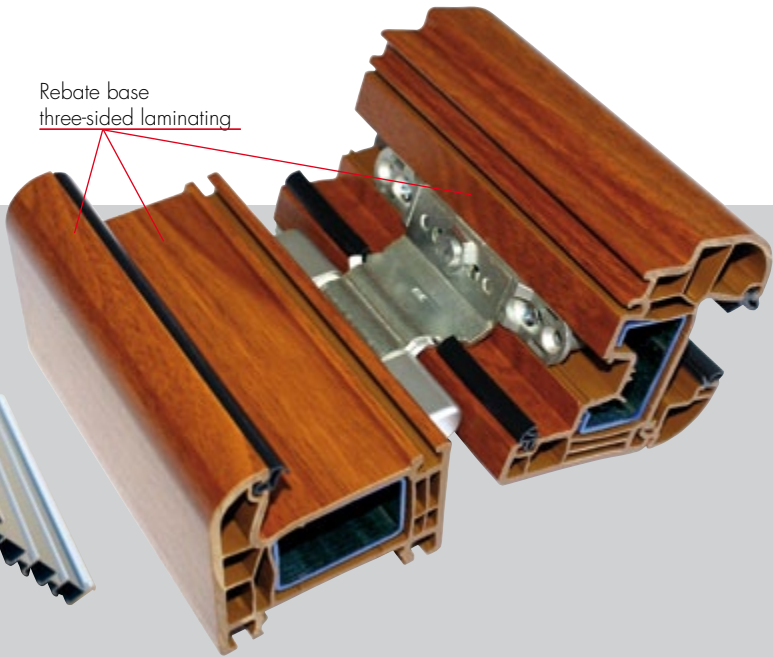

Collection of decorative films

Title	VG	Deco no.	Title	VG	Deco no.	Title	VG	Deco no.
1. Beige	28	F436-5015	65. Gale Grey Finesse	65	9.0049122	Siena PN	75	9.0049237
2. Winchester	31	9.0049240	25. Golden Oak	25	9.2178.001	Siena PR	74	9.0049233
3. Eiche Kolonial (Golden Oak)	70	F436-2076	63. Grau	63	7.155.05-083	Silbergrau	67	F436-5049
4. Noce Sorrento Balsamico	29	F436-3042	71. Kirsche piemont	71	F436-2032	Streifen Douglasie	27	9.3152.009
5. Staufereiche Mocca	46	F436-2048	61. Macoré	61	9.3162.002	Verkehrsweiß	72	F436-7030
6. Staufereiche Terra	30	F436-2035	37. Mahagoni	37	9.2097.013	Walnuss Amaretto	51	F436-3058
7. Walnuss Terra	69	F436-3059	57. Maigrün	57	F426-5016	Walnuss Kolonial	68	F436-3062
Anegré Goldbraun	42	F426-2022	34. Metbrush aluminium	34	F436-1001	Walnuss Rehbraun	66	F436-3063
Anthrazitgrau	52	7016.05-167	35. Metbrush silver	35	F436-1002	Weiss	49	9.152.05-168
Anthrazitgrau	53	7016.05-083	56. Moosgrün	56	6005.05-167	White	33	F426-1809
Anthrazitgrau	54	F436-7003	41. Noce Sorrento natur	41	F436-3041			
Basaltgrau	64	7012.05-167	45. Nussbaum V	45	9.2178.007			
Bergkiefer	39	9.3069.041	62. Oregon 3	62	9.2115.008			
Brillantblau	76	5007.05-167	38. Oregon 4	38	9.1192.001			
Cherry Amaretto	43	F436-3043	55. Pastellgrün	55	F426-5020			
Cremeweiss	50	1379.05-167	58. Rubinrot	58	F436-5013			
Dunkelgrün	59	6125.05-167	60. Sapeli	60	9.2065.021			
Eiche dunkel	47	9.2052.089	36. Schokobraun	36	8875.05-167			
Eiche natur	73	9.3118.076	48. Schwarzbraun	48	8518.05-167			
			40. Shogun AF	40	9.0049198			

Self-adhesive decorative films

New – large selection of self-adhesive window films. Almost all window films are now available from GARGIULO as self-adhesive films – in attractive wood patterns, finely pigmented metallic finishes and versatile single colours.

Description:

Self-adhesive films specially suited for both indoor and outdoor applications. Based on Renolit and Hornschuch with high-quality pressure-sensitive adhesive. For permanent application to smooth surfaces.

Applications:

- Minor repairs to windows
- Production of patterns
- Many different types of handicrafts

How to apply the films:

The best temperature to apply the foil is between +18°C and +35°C. The initial adhesion strength is not as high at lower temperatures. Good adhesive bonds are achieved on smooth surfaces. The surface to which the films to be applied must be dry and clean. Dust, fat, oil and other separating agents will have a negative effect on the adhesive bond and must be removed before the foil may be applied. We recommend that water or soapy water with clean cloths be used to initially clean the surfaces. Stubborn dirt may be removed with material-compatible solvents.

You should proceed as follows:

1. Thoroughly clean the surface to which the films to be applied.
2. Cut the films roughly to size. Cut the pieces as short as possible. The foil should be wider than the area to be coated.
3. Press on with a roller and/or squeegee.
4. Cut overlapping foil to size so that it is flush with the surface.

Advice: If the achieved adhesion is not sufficient, you may heat the films after application with a hairdryer and then again press on firmly. It is also helpful to heat the surface to be covered before applying the films.

Adhesive properties:

The pressure-sensitive adhesive film used on these products delivers particularly good results when used on PVC, polycarbonate, ABS, metal, glass and ceramic. The pressure-sensitive adhesive may also be used on smooth wood. It guarantees highest resistance to ageing and UV light. It is also resistant or highly resistant to many oils, fats, cooling lubricants, acids, lye, disinfectants, fuels and many other chemicals. The high initial tack delivers a high level of reliability after application. Final adhesion is achieved after around 24 hours. Temperature range: -30°C to +120°C.

Benefits:

- Simple use.
- May be used at site.
- No tooling costs, therefore low cost.
- May be applied without machines, only simple tools are required.
- Fast and practical, universally applicable, „the ideal problem solver!“
- Easy-to-remove protective paper.



Disadvantages:

- Not comparable with machine-applied materials.
- No intention to achieve a strong adhesion requirements as the film is removable.

Prices:

One roll (100 mm wide, 10 running meter): 45.00 EUR, plus VAT, plus shipping.

The minimum order quantity is two rolls. One roll with 20 running meters may be alternatively ordered.

Delivery sizes:

100 mm wide rolls with 10 running meters.

Other widths and lengths are possible on inquiry.



Storage:

Self-adhesive films should be stored at room temperature and normal humidity (50-70%). The maximum storage period of four months after shipping will then be achieved.

Note:

We do not recommend that window profiles be fully or partially covered with self-adhesive foil. The adhesion is just not as good as conventional bonding using reactive PUR hot-melt adhesives. We therefore cannot assume any liability. Our information is based on practical experience and tests we have carried out. We do not provide any guarantee for the information provided here. We consequently recommend that you carry out your own tests before commencing work.

Simple tools are required to apply the foil:

A hand squeegee with integrated roller and felt edge is available from us for **8,40 EUR plus VAT**.

You will also require a foil knife, rule and scissors.



Pultrusion of fibre glass (GFK)

The newest production technology of GARGIULO is the pultrusion process. In this process the profiles made out of plastic which is reinforced with fibre glass are produced in a continuous process. These profiles are used for example in frame of steel for windows.

GFK = plastic reinforced with fibre glass

■ Advantages of GFK:

- wide variety as it is malleable
- low net weight
- low thermal diffusivity
- high corrosion resistance
- long duration of life
- sound absorbing
- absorbent
- not electrically conductive
- high termical stability
- high impact strength

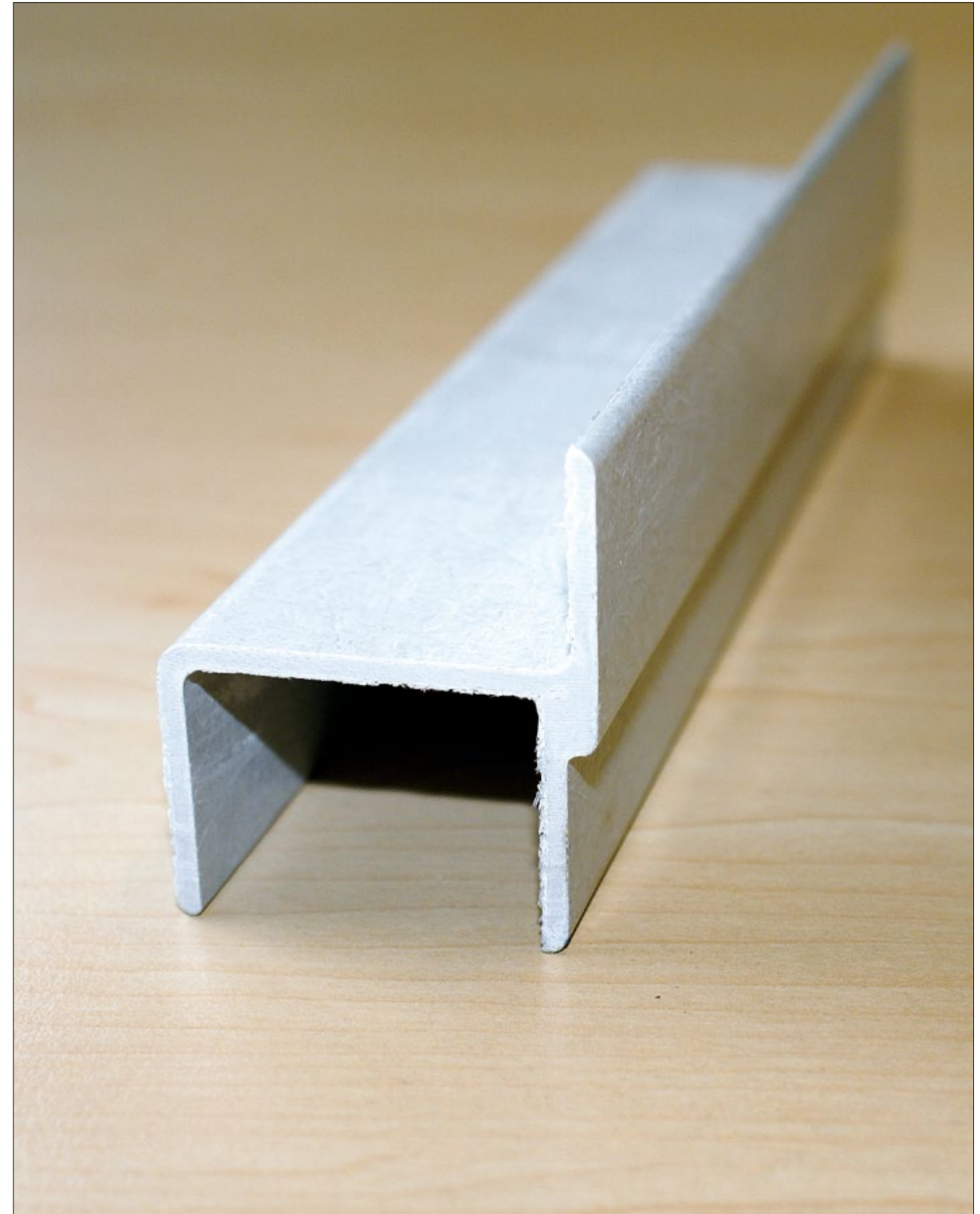
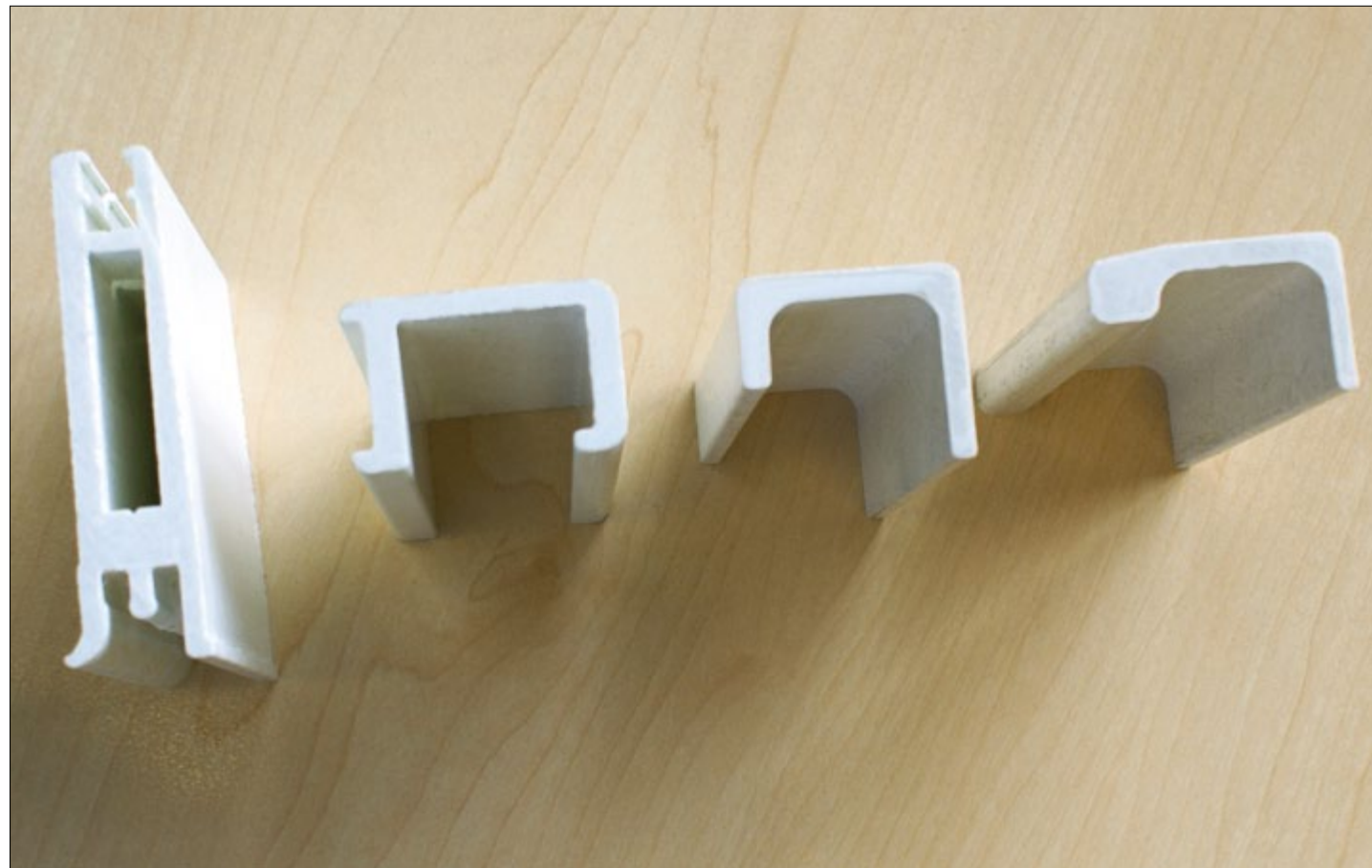

VG-PE INSULATION MATERIAL

Closed-cell PE foam profiles (polyethylene) in silver-grey that improve insulation values (Uf) on aluminium, steel and plastic window systems.

The material may be used in the glazed rebates on all windows and facade systems. It may also be used between the composite strips on aluminium systems and in the hollow chambers on plastic systems from an adequate cross-section size. The profiles may be finished with self-adhesive coatings on one side, with removable silicone covering on rolls from a diameter of 1200 mm or with metal foils where smaller quantities are required (100-200 m). Many other types of adhesion are also possible due to the good surface structure with closed cells.

Delivery types:

VG-PE profiles are available in different sizes and packaging. Rolled on cardboard spools, in cardboard boxes or cut to length. Roll lengths and box contents depend on the shapes, custom-made products available on request!

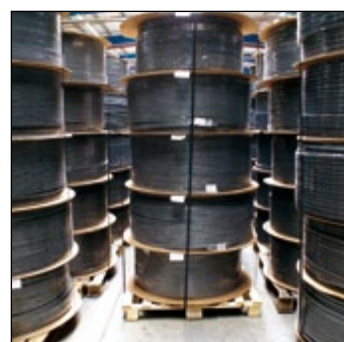
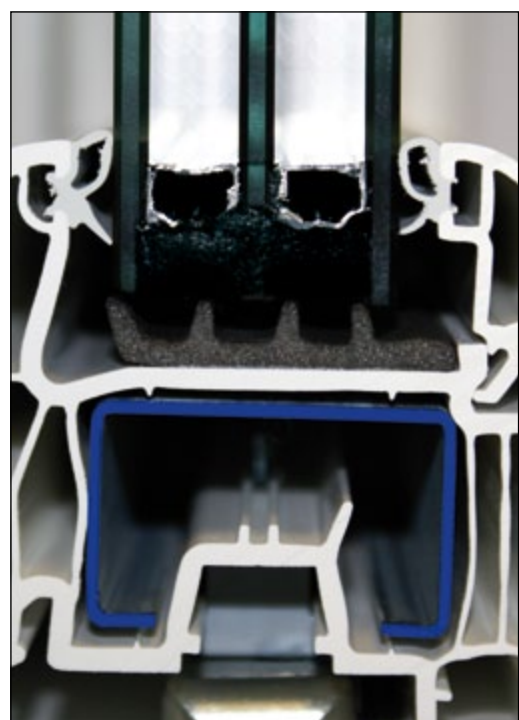

Properties:

- Moulded density range between 25 and 40 kg/m³
- Variable thickness range possible from 2.5 mm (contour-dependent)
- Excellent physical properties
- Good impact elasticity, low compression set
- Available with fire-retardant finish in accordance with various standards, otherwise normally inflammable in accordance with DIN 4102-1, B2
- Fine, regular and closed cell structure
- Excellent heat insulation properties, very good λ -value
- Low water absorption and very low vapour permeability
- Good resistance to weathering
- Excellent resistance to chemicals
- Inert in regard to a variety of chemicals
- Free of softeners, odourless
- Environmentally neutral, no special identification required, no hazardous materials
- Easy reuse of wastes: recycling, landfill or incineration (VG-PE can be granulated and reused)
- For technical data please refer to the VG-PE datasheet



PS-Mouldings

The PS profiles, which are made out of expanded or formed expanded polystyrene, have excellent insulation values for the window construction. GARGIULO utilises these PS profiles also as decorative mouldings due to their uniquely exact solid and smooth surface.



19MG = 100x95



20MG = 130x120



130ML = 130x105



14MG = 70x70



17MG = 80x80



100ML = 70x70



12MG = 52x56



13MG = 55x80



60U = 60mm



10MG = 40x45



11MG = 50x50



40U = 40mm



7MG = 34x50



8MG = 30x30



25MG = 100x75



110MC = 110x100



50MC = 50x50



22MG = 105x125



80MC = 80x80



30MG = 80x80



26MG = 115x60



21MG = 110x110

Floorboard ENZO-D



- **Wood Plastic Composites:**
the floorboards are composed of high quality WPC-material
- **Quality:**
WPC has been used for more than 30 years with great success
- **Easy to clean:**
for surface purification
- **Anti-slip-system:**
through brushed surface
- **WPC-material:**
50% wood + 50% PVC
- **Production:**
100% Made in Germany



- **Guarantees high quality**
- **100% recyclable**
- **WPC and the rainforest survives**



Guarantees a high mechanical stability, resistance and colour fastness, like wood.

1 m² surface are the result of 2 floorboards. Measures of the floorboards: 3000 x 160 x 25 mm

Available in the colours:

- 74 CHOCOLATE BROWN
- 75 BLACK
- 76 CEDAR
- 77 RED BROWN
- 78 LIGHT GREY

Accessory:

- Substructure bar
- T-connecting piece
- Screws

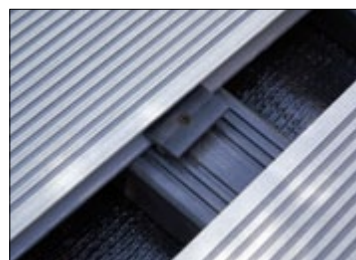

Laying instruction

and test reports:
www.mondo-gargiulo.de/bodendiele

Note:

The product is made out of a natural raw material. Changes in colour can occur caused by the weather.

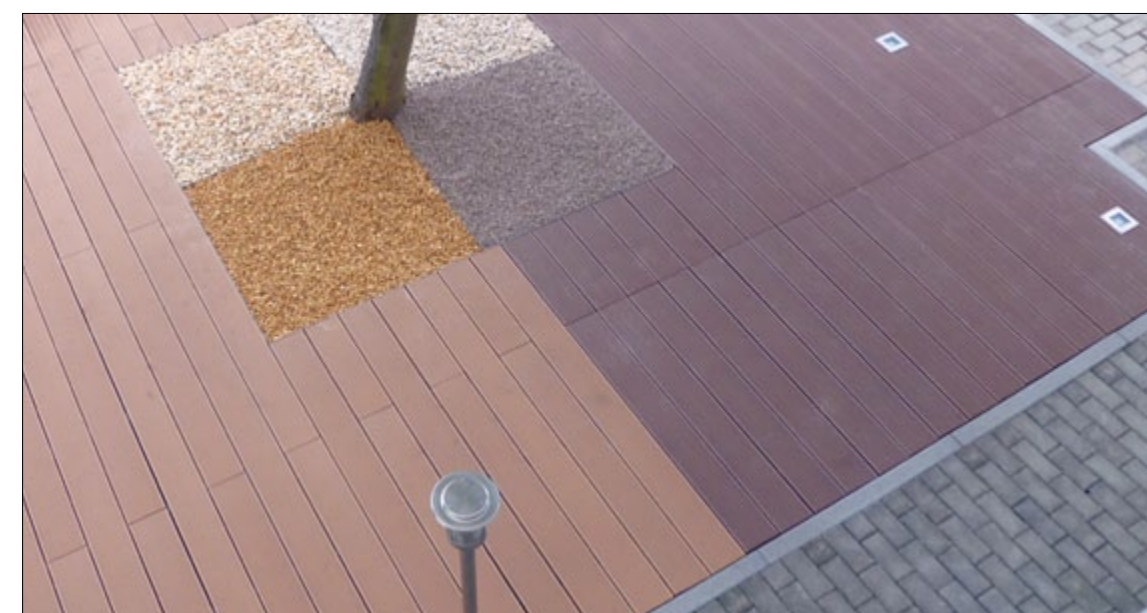
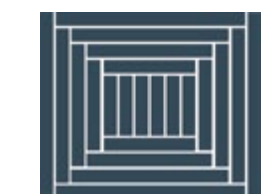
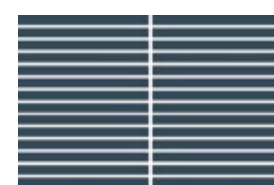
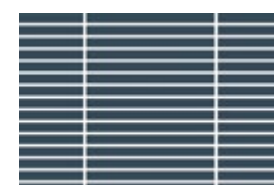

CEO
Vincenzo Gargiulo



History

- 1989 Foundation of the company "Vincenzo Gargiulo Extrusionstechnik" based in Oferdingen
- 1990 Relocation of the company to Bodelshausen
- 1994 New building, Plant 1, Oferdingen, production plant with an area of 1.300 m²
- 2000 New building, Plant 2, Oferdingen, production plant with an area of 1.200 m²
- 2003 Foundation of the company "Vigarex GmbH"
- Expansion of the company with Plant 3, production plant with an area of 5.700 m²
- 2004 Taking-over of the company "Adolf Härle Fensterbau"
- 2006 Product extension: WPC wood / PVC extrusion
- 2007 Merger of the company "Vincenzo Gargiulo Extrusionstechnik" and "Vigarex GmbH", called "GARGIULO GmbH"
- 2008 Product extension: PS-mouldings and PE-foam isolation
- 2009 Expansion in Nehren with the logistic centre
- 2010 Expansion of the company with Plant 4, Nehren, production plant with an area of 1.2000 m²
- Product extension: Lamination
- 2011 Product extensions: Pultrusion

BUSINESS FIELDS

Machine construction - Tool manufacturing - Extrusion - Window construction - Mouldings PS - PE Insulation material - WPC profile - Lamination - Pultrusion

FACTS

2002 :: turnover 4,5 million Euro	2009 :: turnover 16 million Euro	2011 :: turnover 25 million Euro
::: 50 employees	::: 120 employees	::: 150 employees

PRODUCTION IN FOUR PLANTS

- Production surface of 8.200 m² in Oferdingen
- Production surface of 12.000 m² in Nehren
- Outdoor storage surface of 20.000 m² in Oferdingen and Nehren

RECYCLING

The residual material from the development and production is 100 % recycled in the plant 4, Nehren. Therefore there aren't any disposal problems and we can optimise the use of the raw materials.



PLANT 1 - PS department, machine construction

Hafnerstrasse 58, D-72131 Oferdingen



PLANT 2 - Extrusion, administration

Hafnerstrasse 60, D-72131 Oferdingen



PLANT 3 - Window construction, tool manufacturing, extrusion

Haidswärze 23, D-72131 Oferdingen



PLANT 4 - Corporate management, extrusion, recycling, PE-department, lamination

Daimlerstrasse 21, D-72147 Nehren

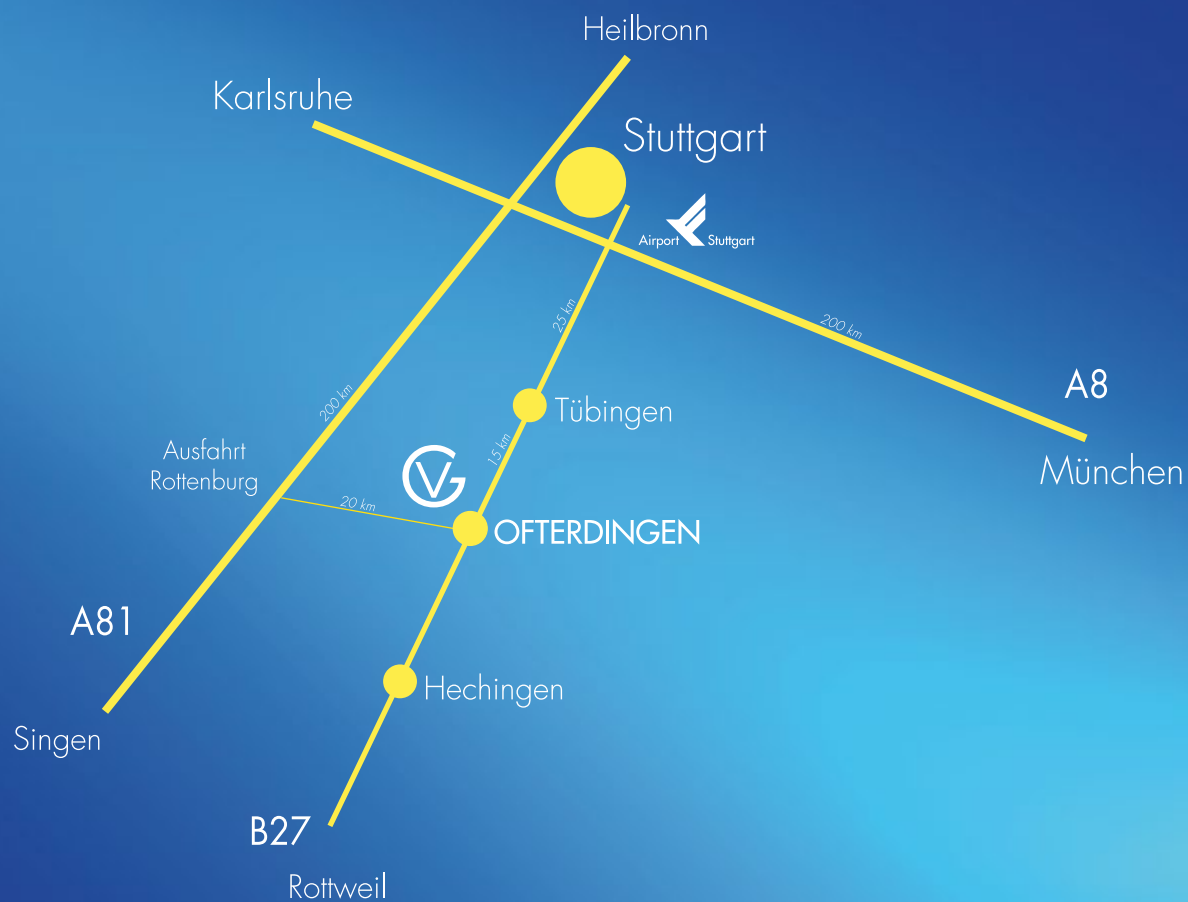

Distribution partner of GARGIULO GmbH

GARGIULO GmbH

Hafnerstrasse 60
D-72131 Offerdingen

Phone: +49 (0) 7473 9438-0

Fax: +49 (0) 7473 9438-250

E-Mail: info@gargiulo.de

www.gargiulo.de